

Windmill

Authors: Yevheniia-Hanna Danyliv, Uliana Koryakina, Andriy Nesterenko, Oleksandra Prysiashniuk, Nazar Tserna

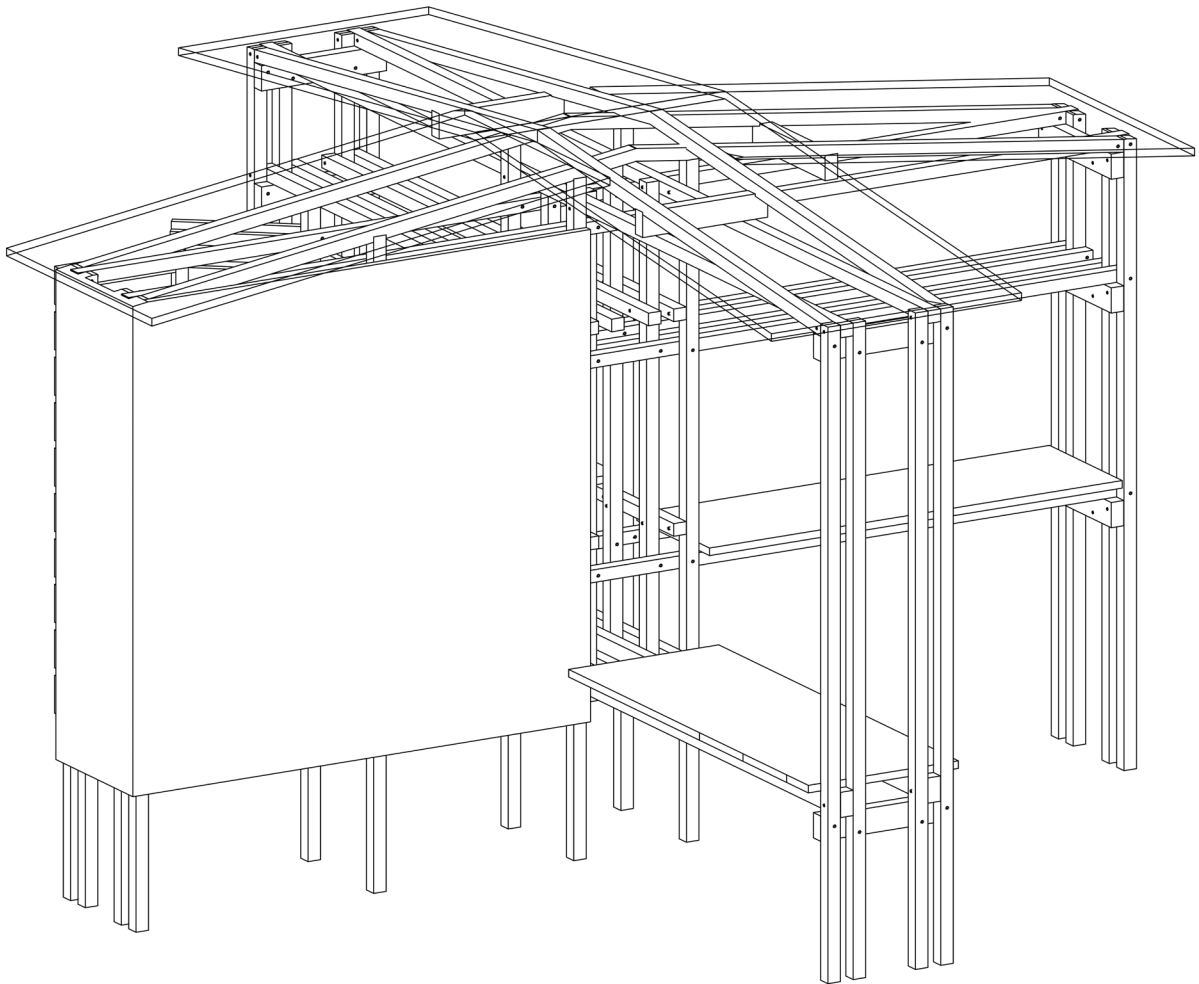

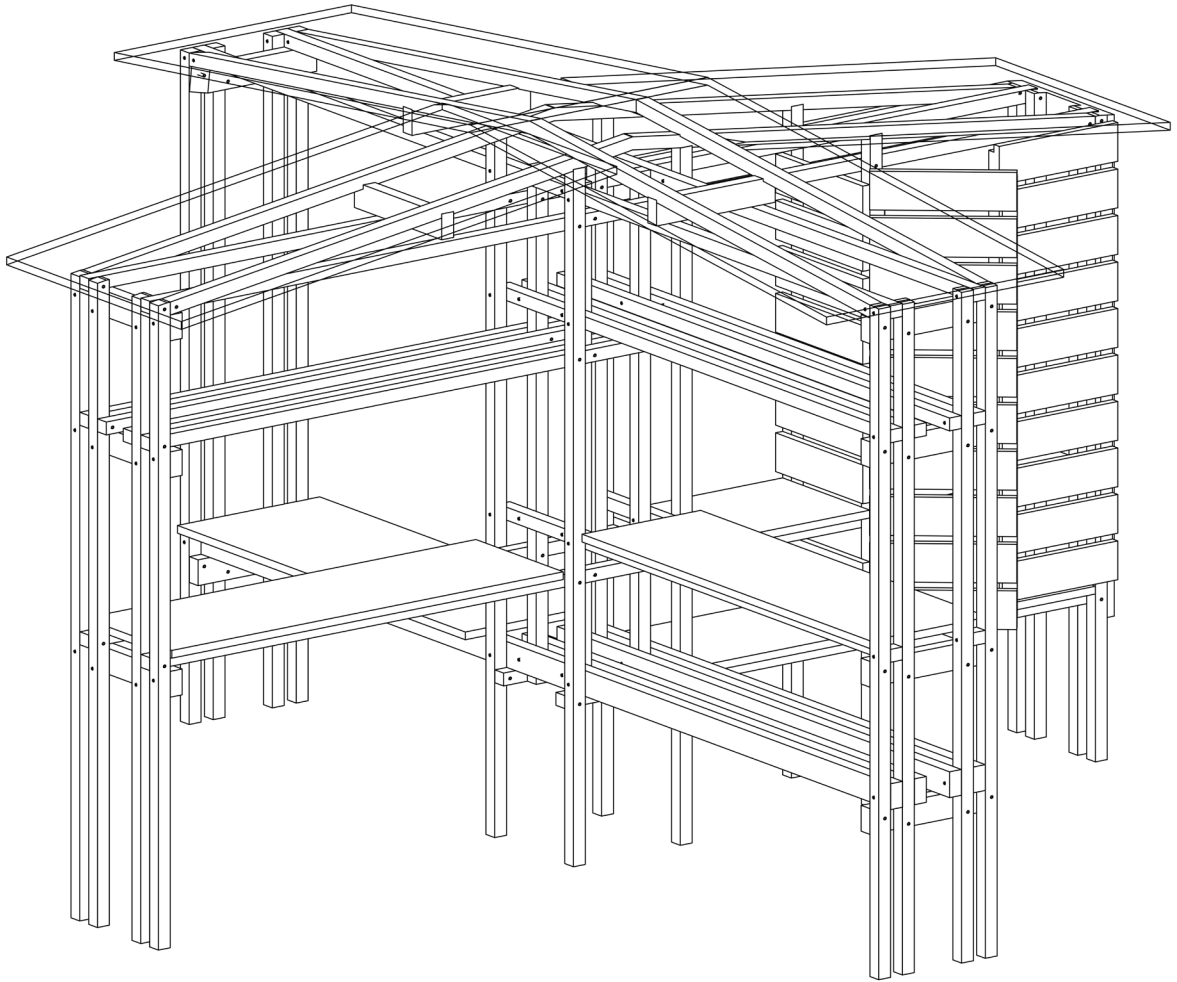

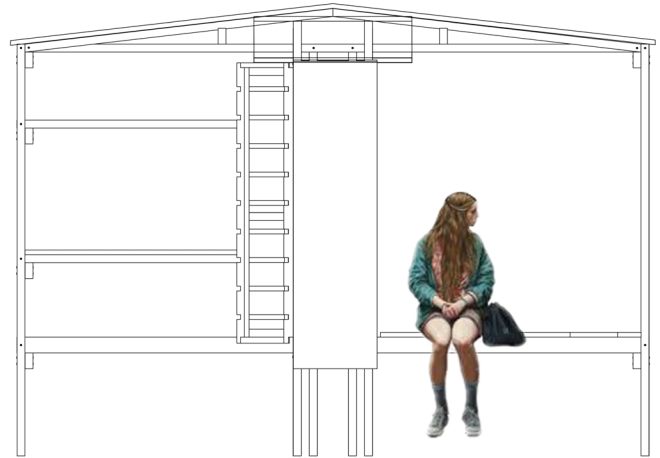
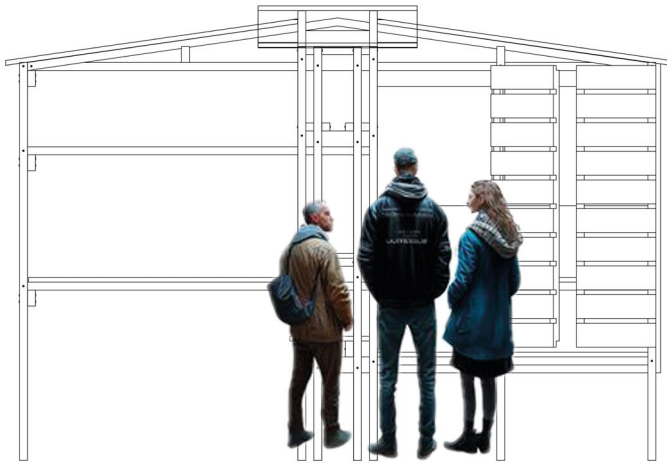
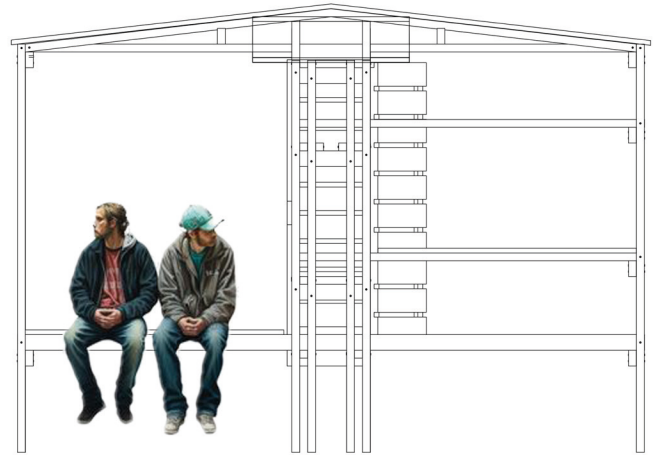
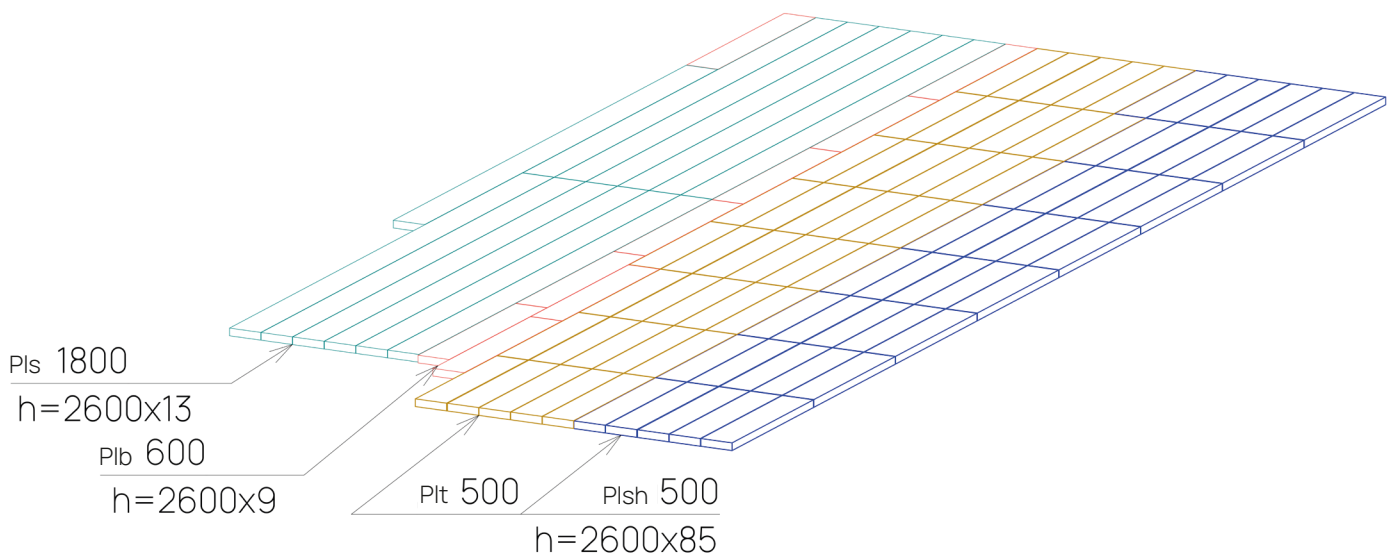

Wood:

Planks:
30 x 150 x 4000 - 18 psc.

Beams:
50 x 50 x 4000 - 44 psc.
100 x 50 x 6000 - 4 psc.

Roofling:

Connection profile
H-shaped 1000*4 - 2 psc.
Polycarbonate 1000 x 3000 - 4 psc.

Finish:

Hard-wax oil wood finish - 12 l.
Bitumen Mastic -1 kg.
Paint brush 100 mm - 3 psc.

required materials & cutting

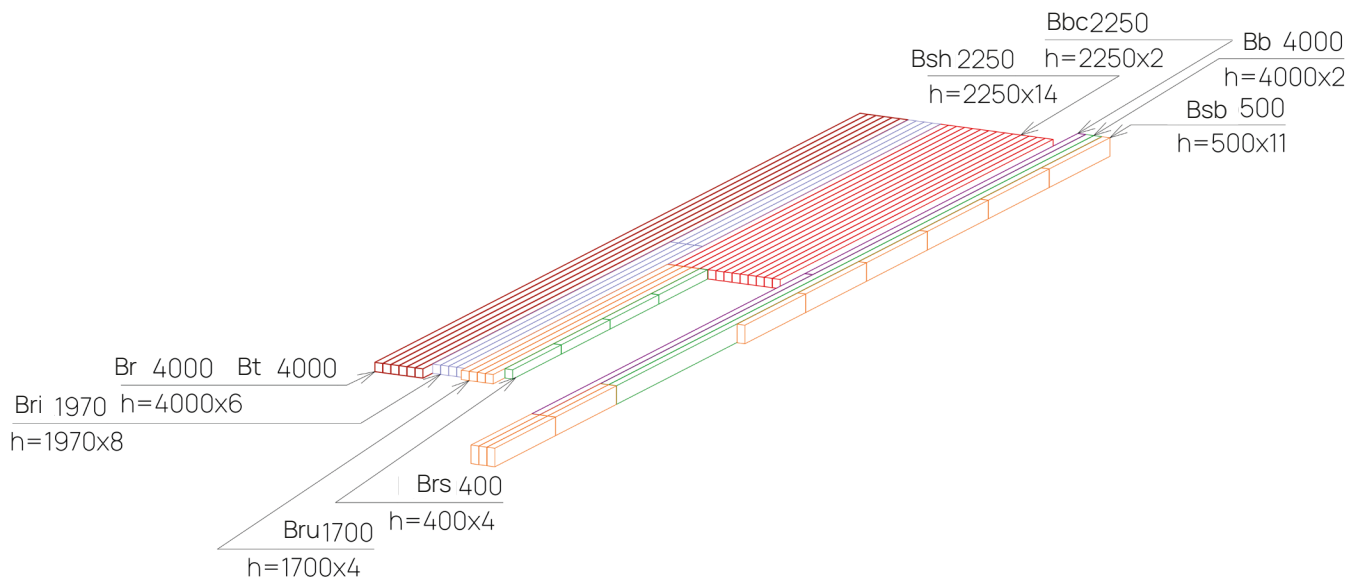

Кріплення

- Stud 8*250 - 6 psc.
- Stud 8*180 - 58 psc.
- Decorative hinge 80x63 - 8 psc.
- Bolt M8x120 - 86 psc.
- Self-tapping screws 50 - 460 psc.
- Self-tapping screws 35
- Hex nut 8*13 - 214 psc.
- Flat washer 8 mm - 214 psc.

Additional:

- Drill bits:
- Wood drill bit 9 mm - 3 psc.
- Wood drill bit 4 mm - 3 psc.
- Crown drill bit Bi-metal 30 - 1 psc.

- Grinding wheel 80 125 mm - 3 psc.
- Grinding wheel 60 125 mm - 3 psc.
- Jigsaw blade set

- Masking tape
- Tape measure
- Wrench 13 mm

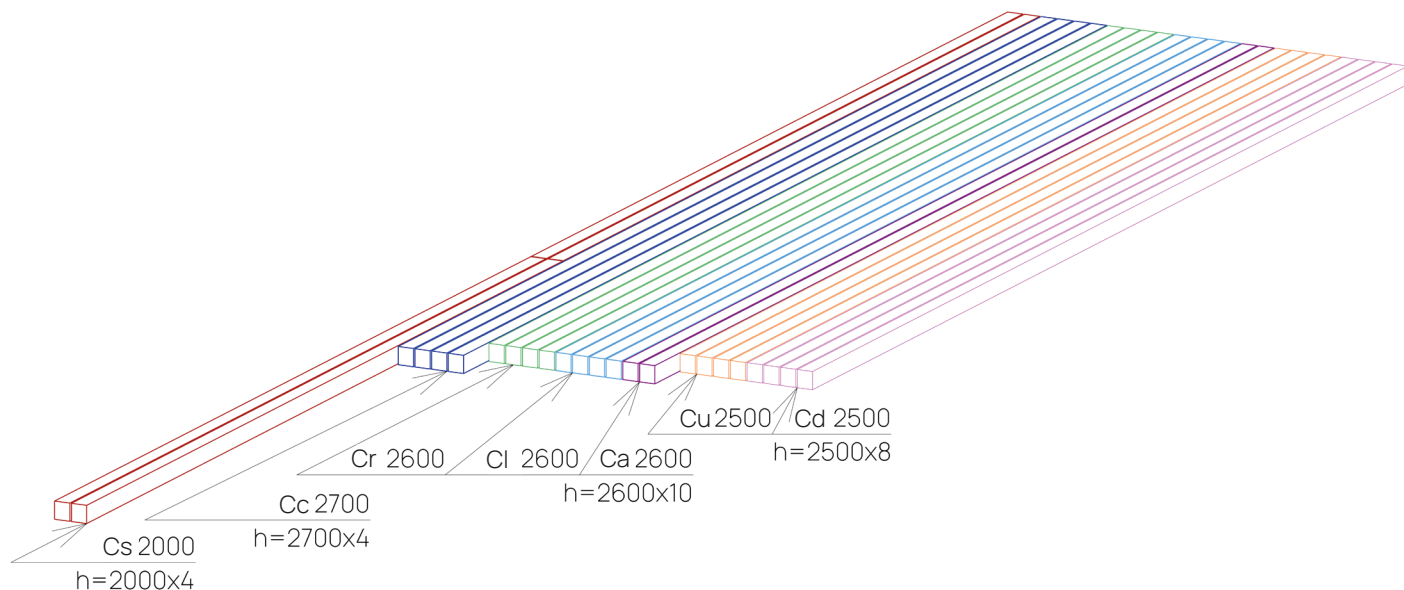

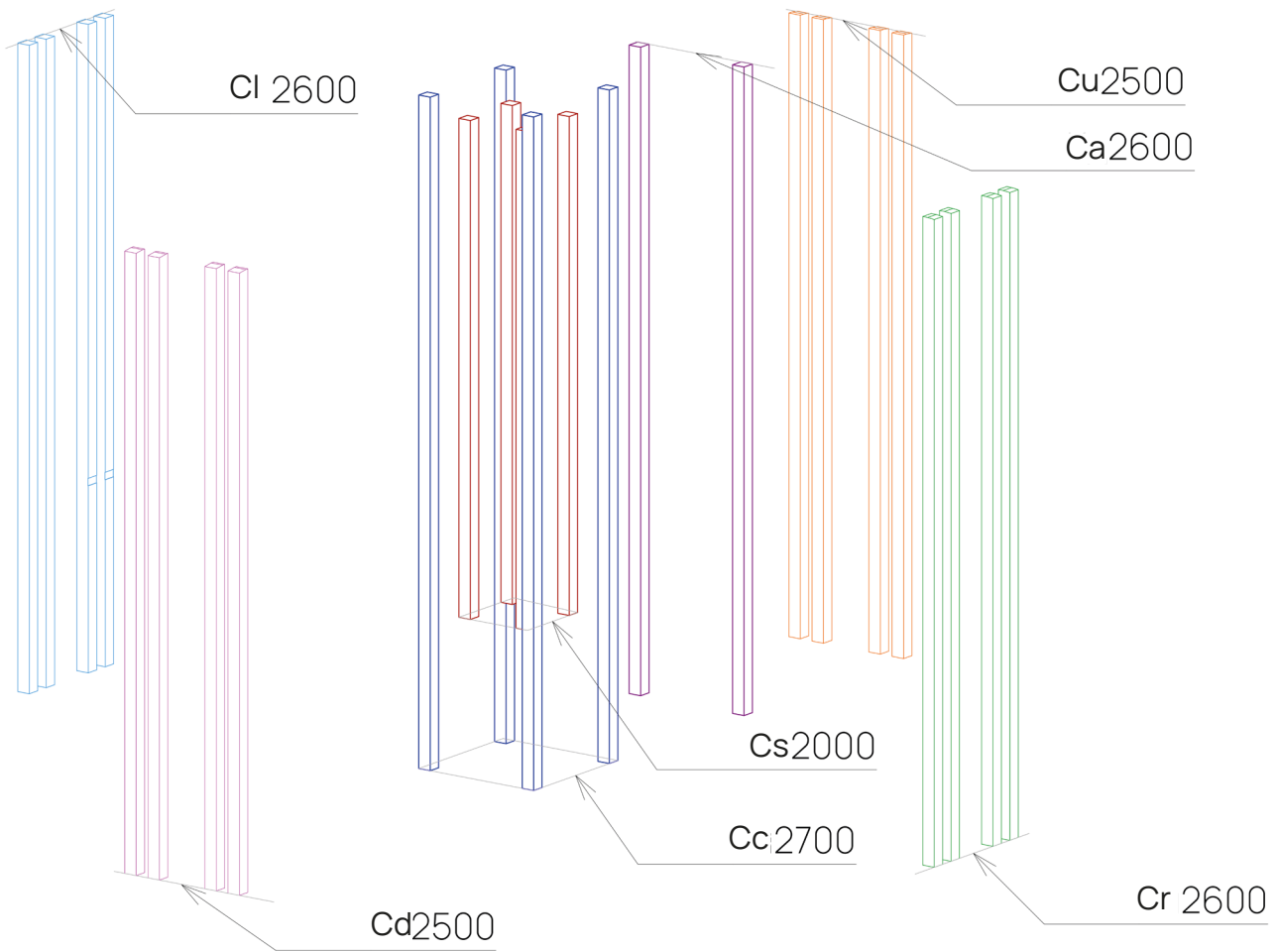
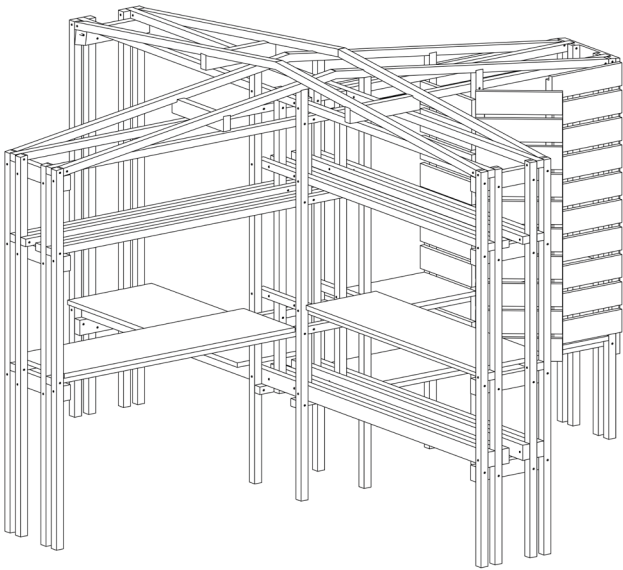

drilling

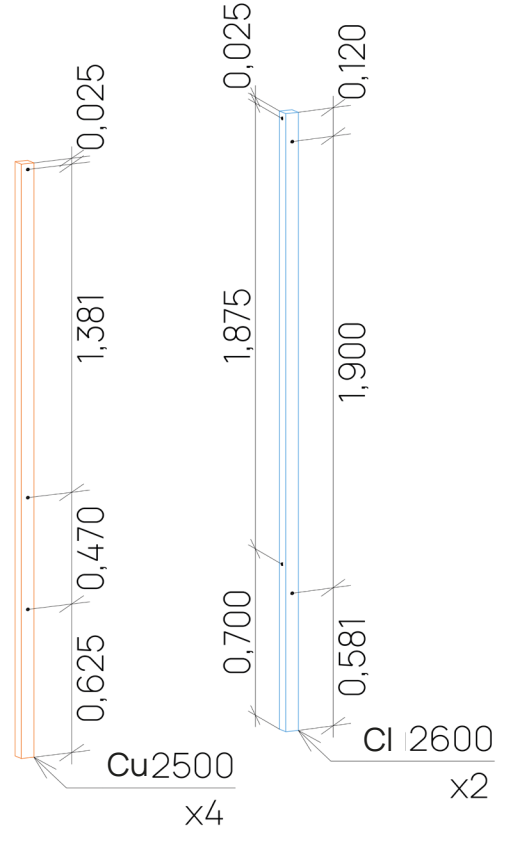
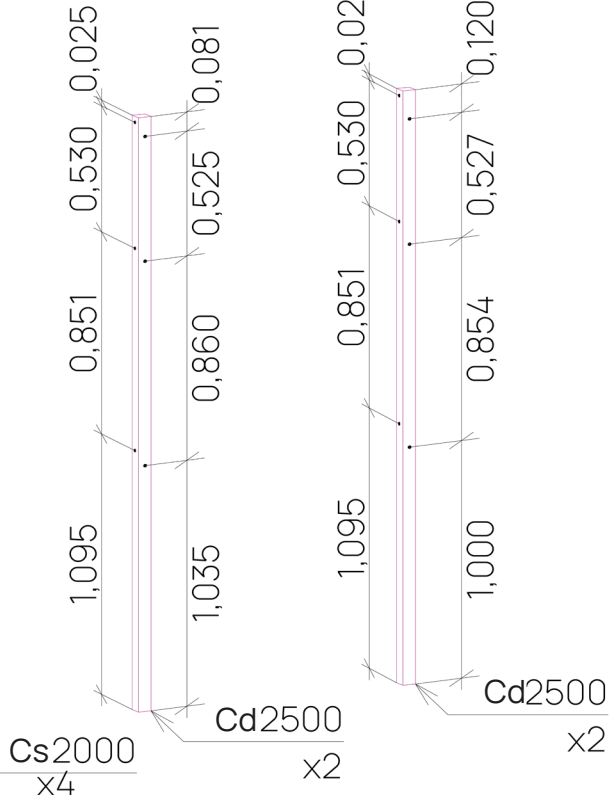
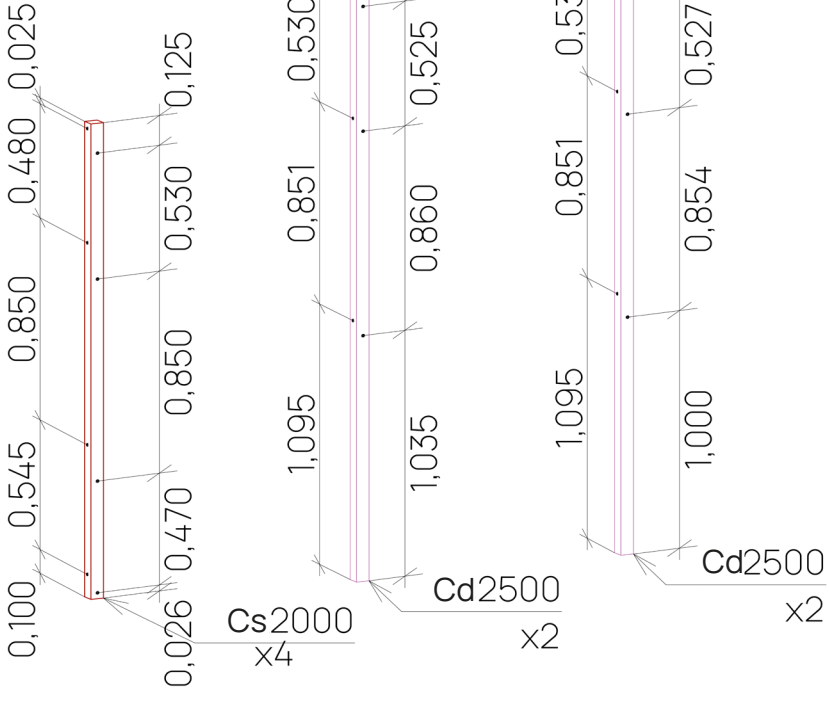
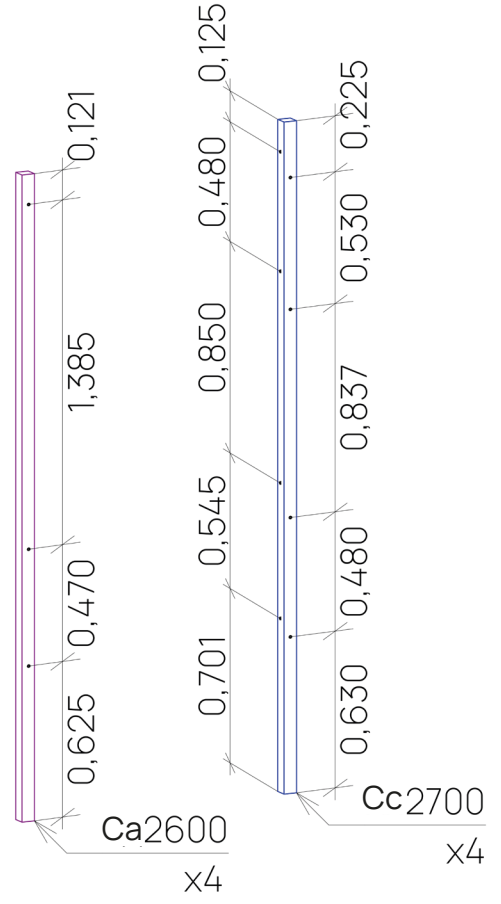
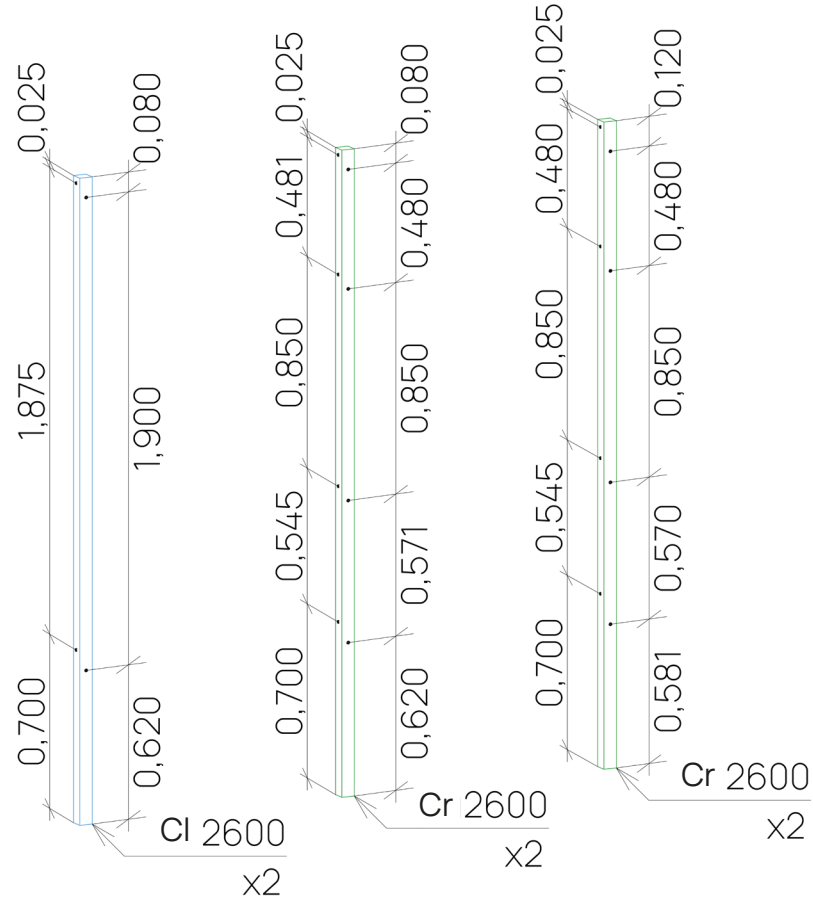

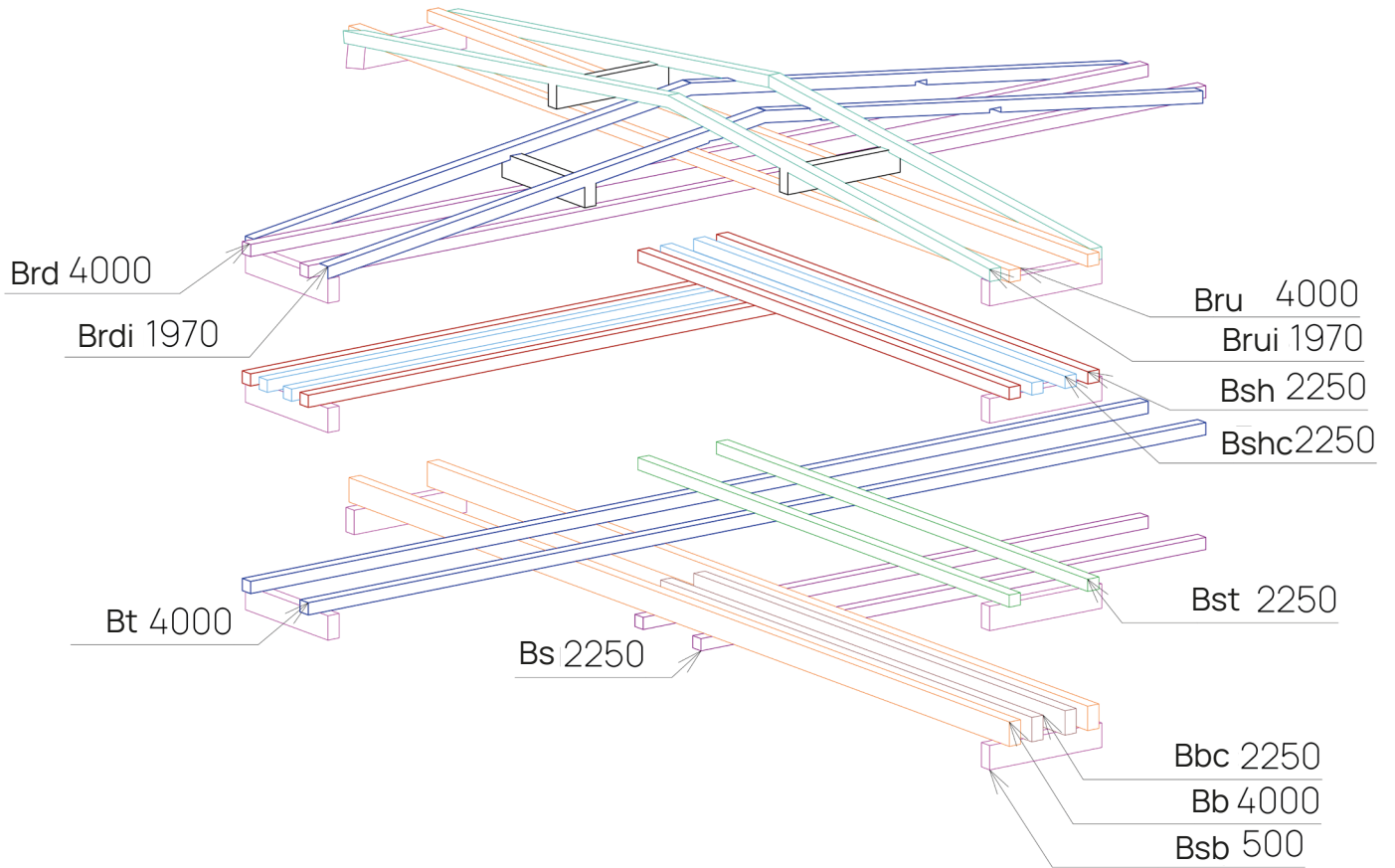
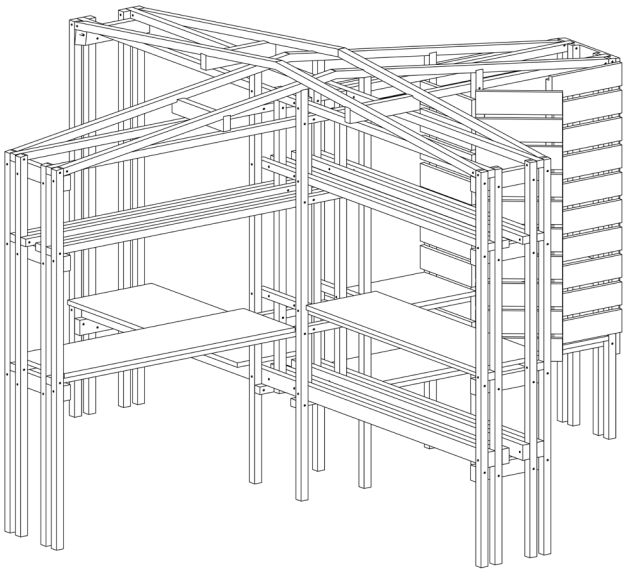

drilling

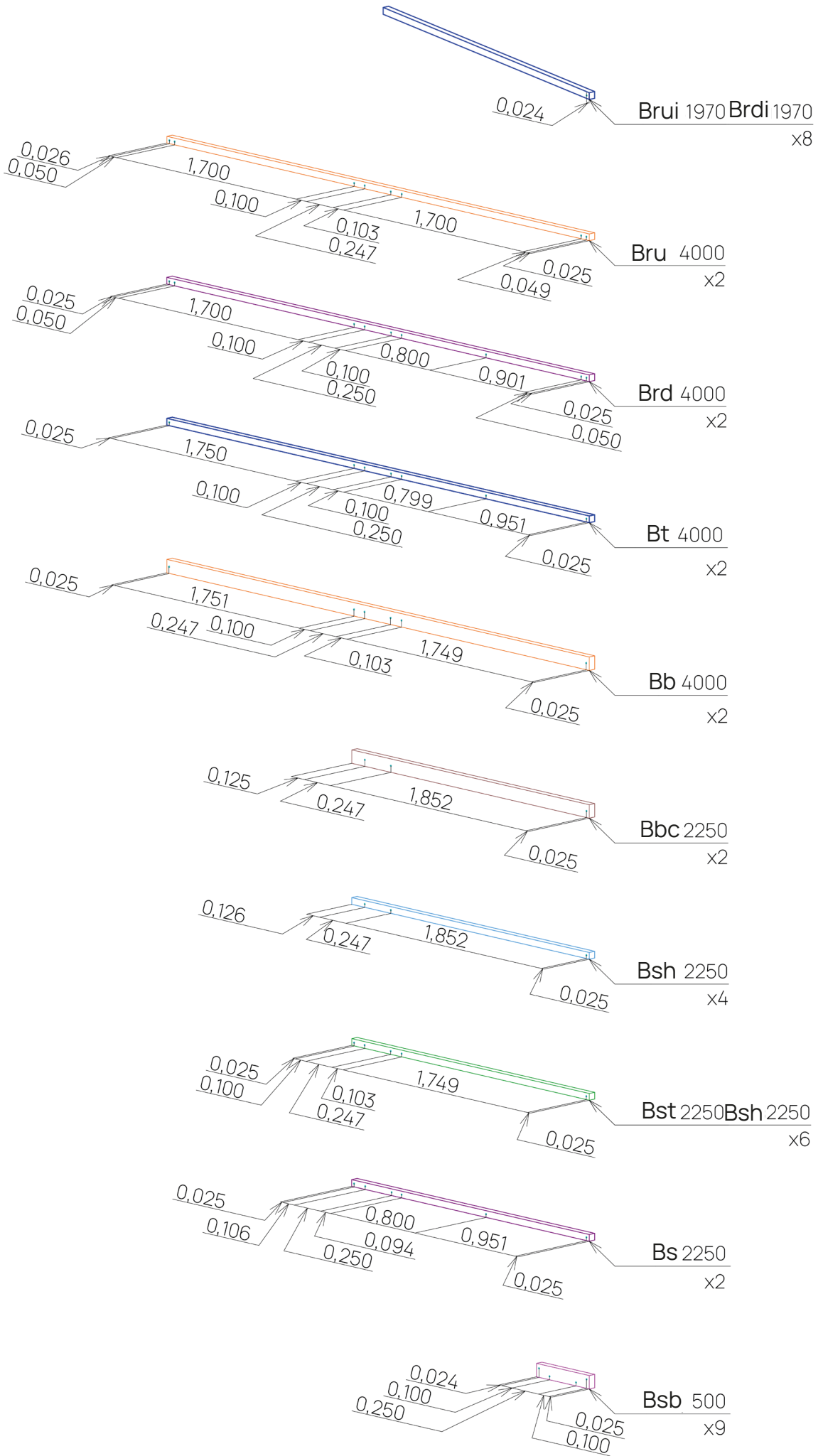

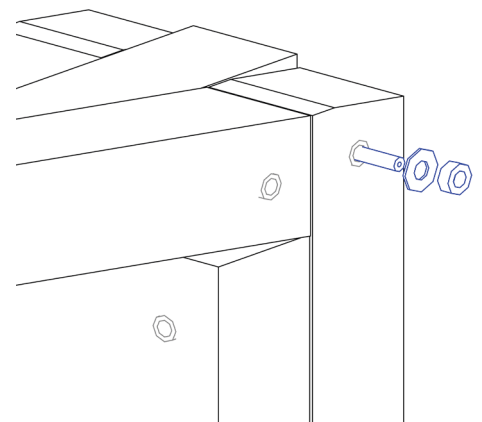
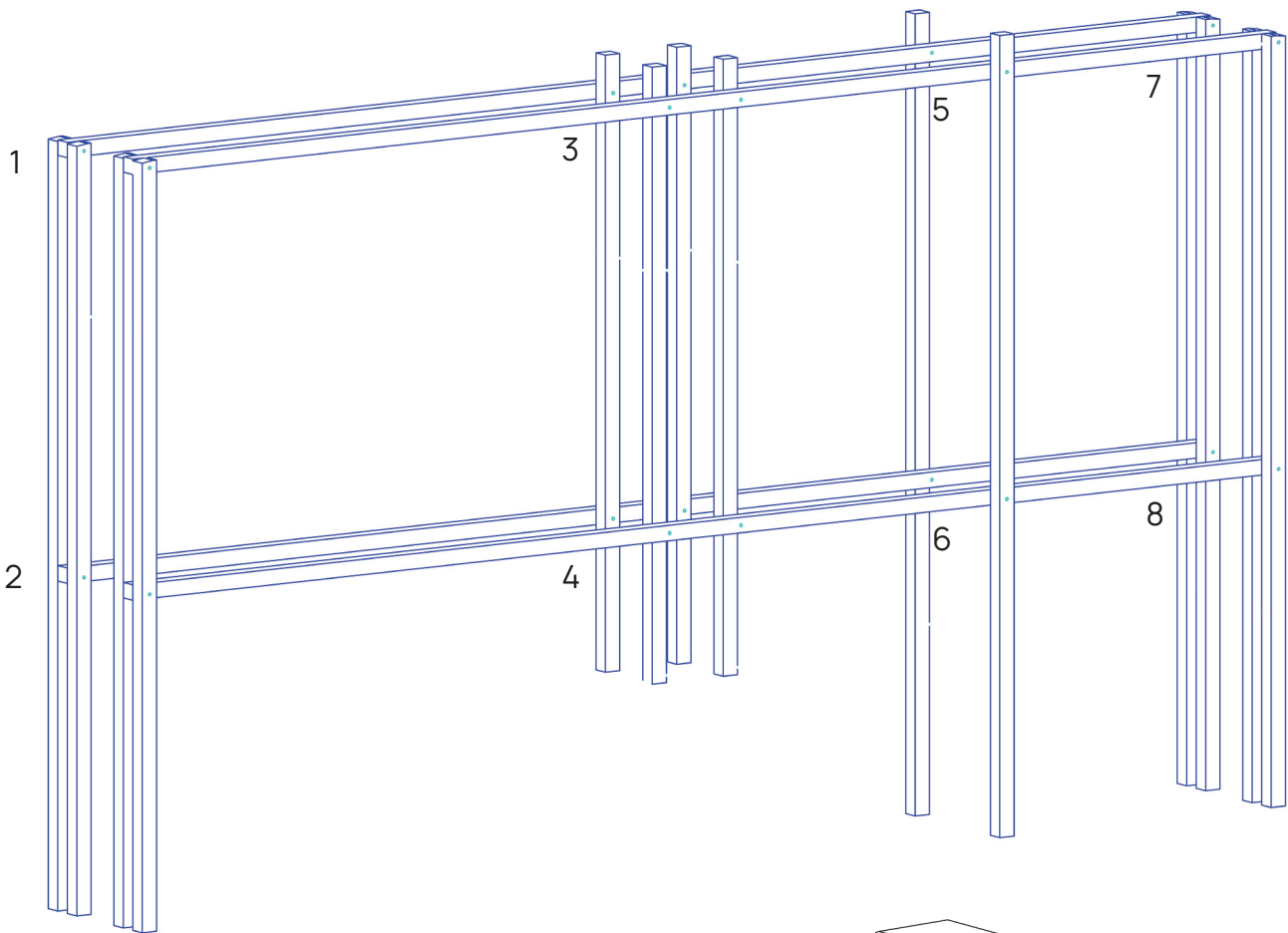
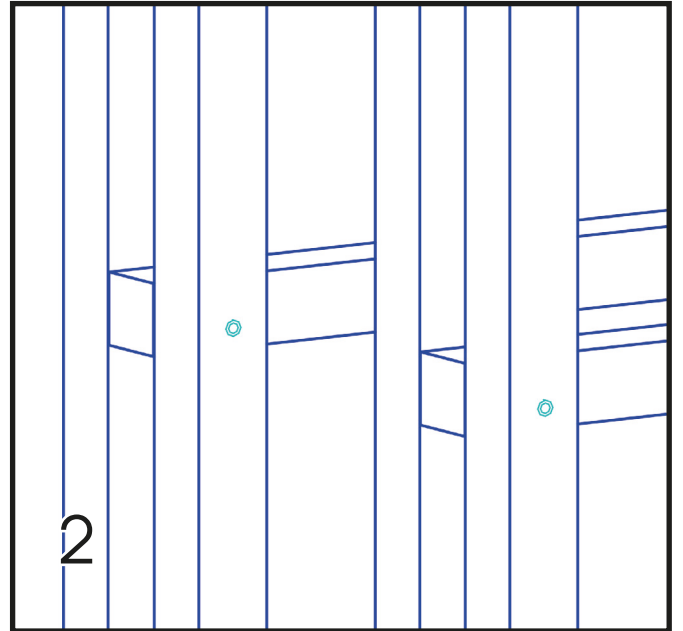
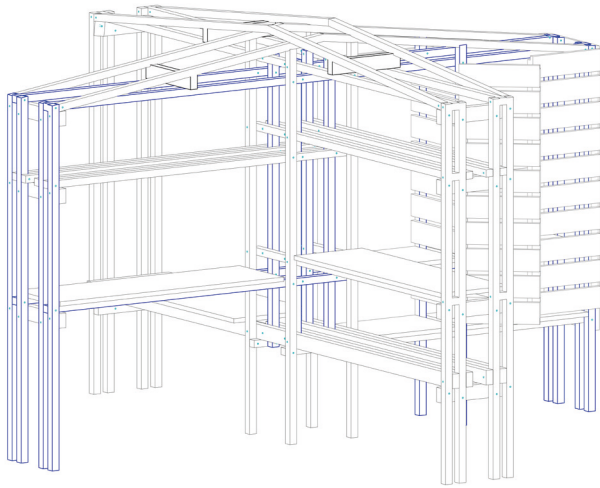

frame assembly

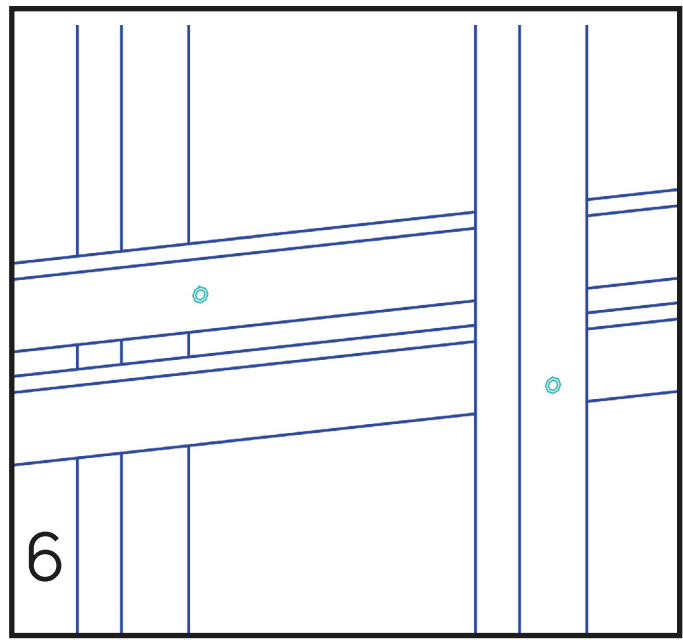
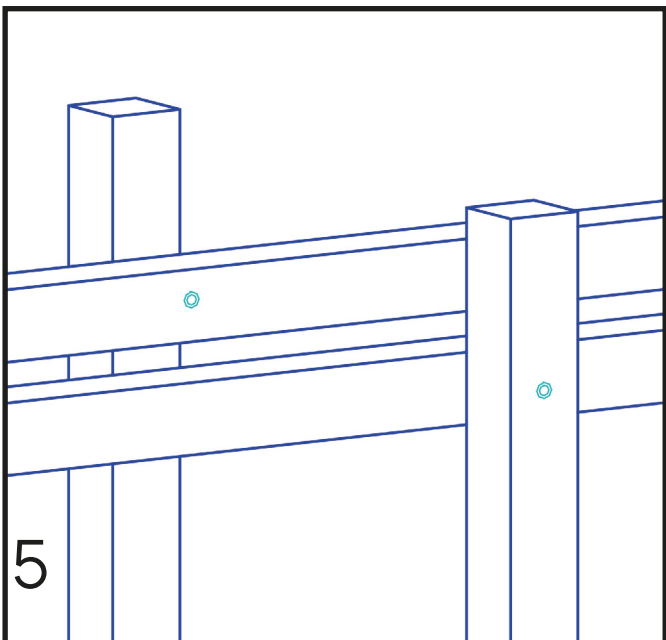
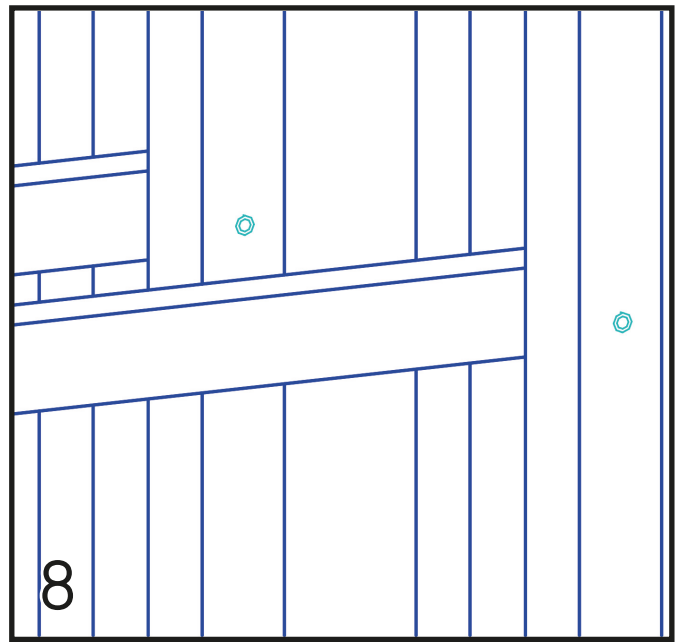
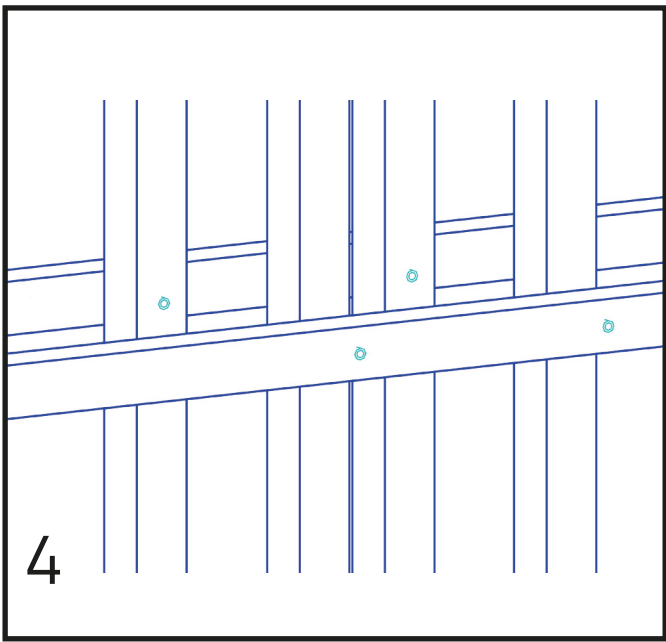
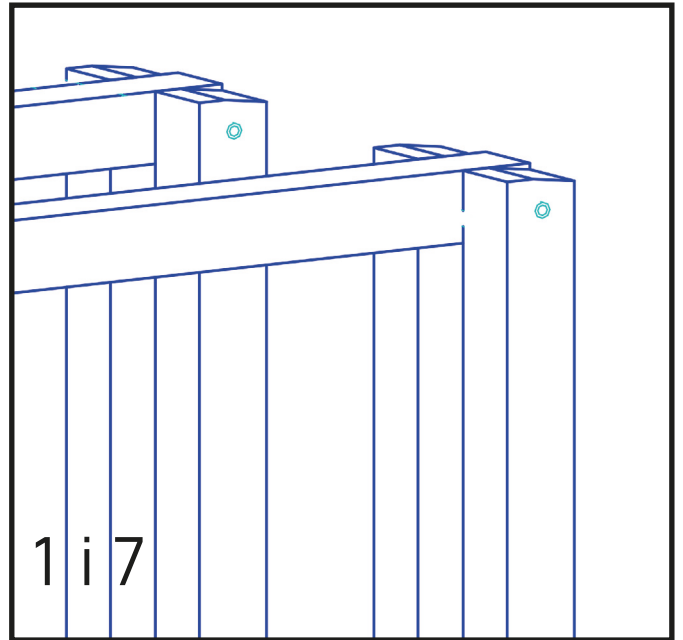
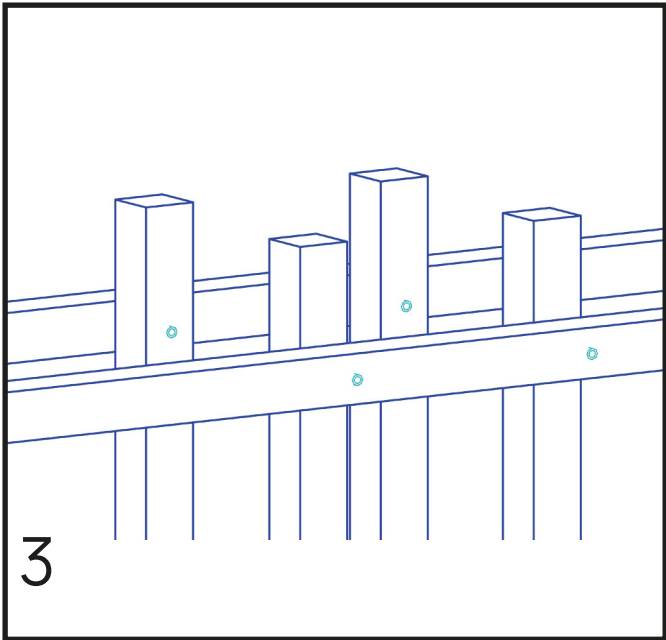

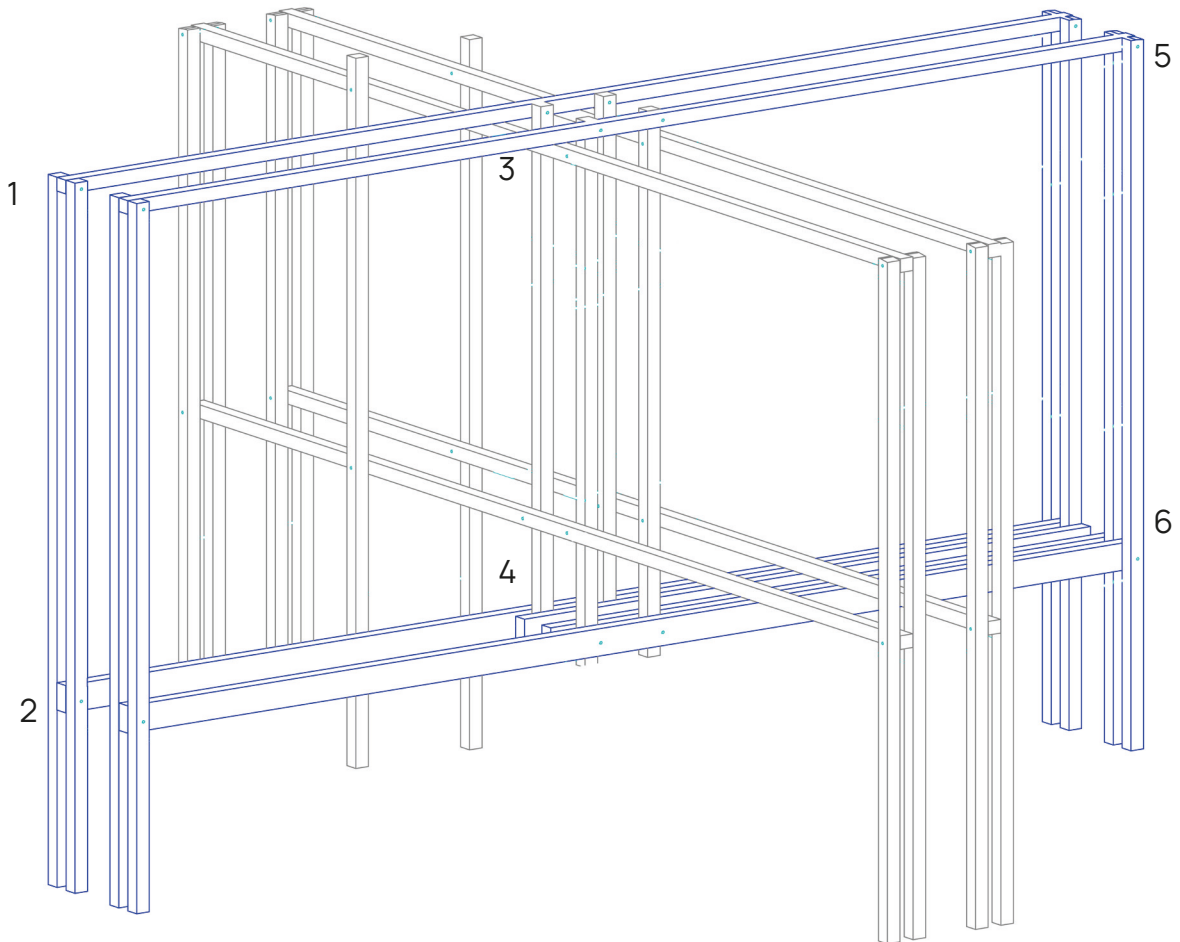
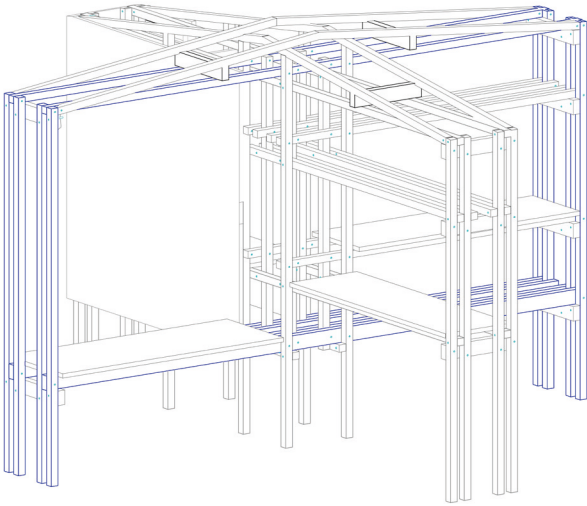

frame assembly

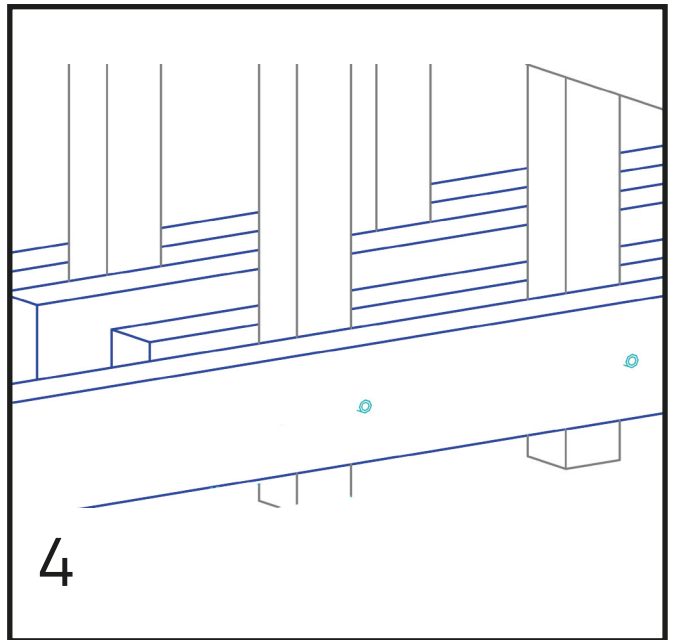
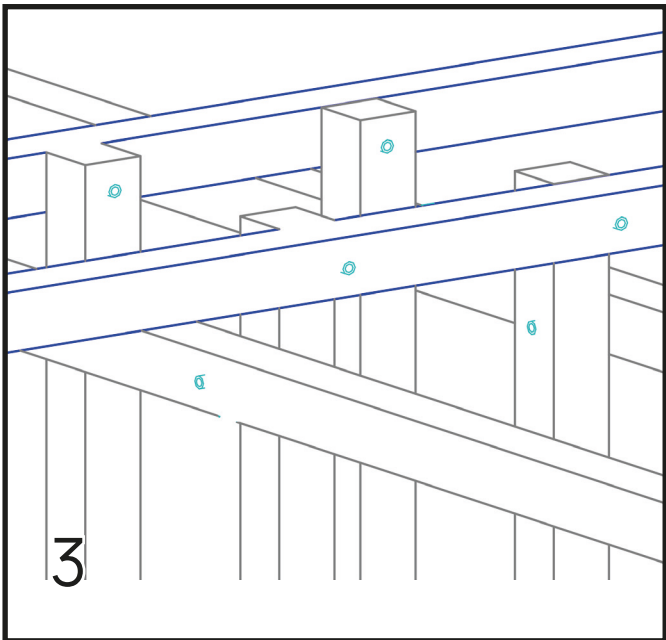
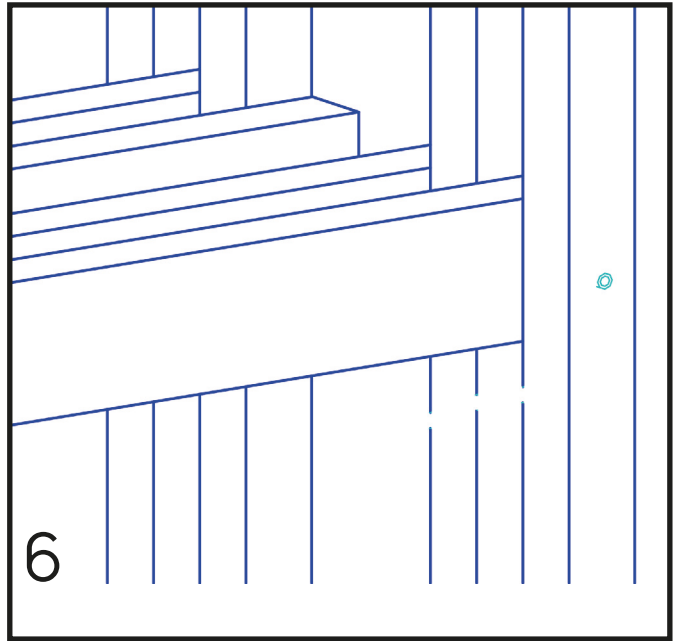
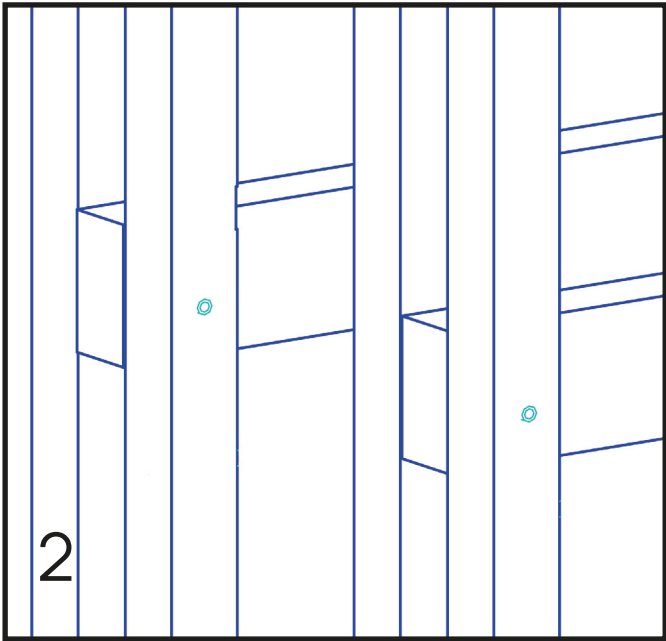
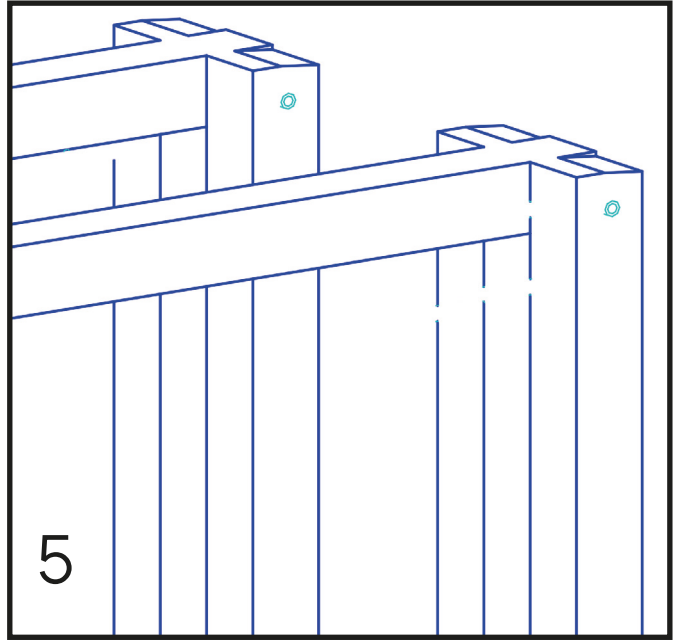
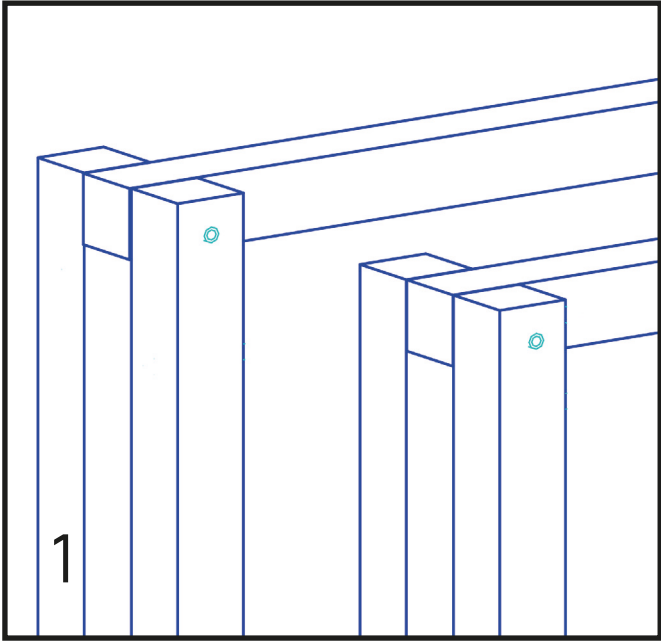

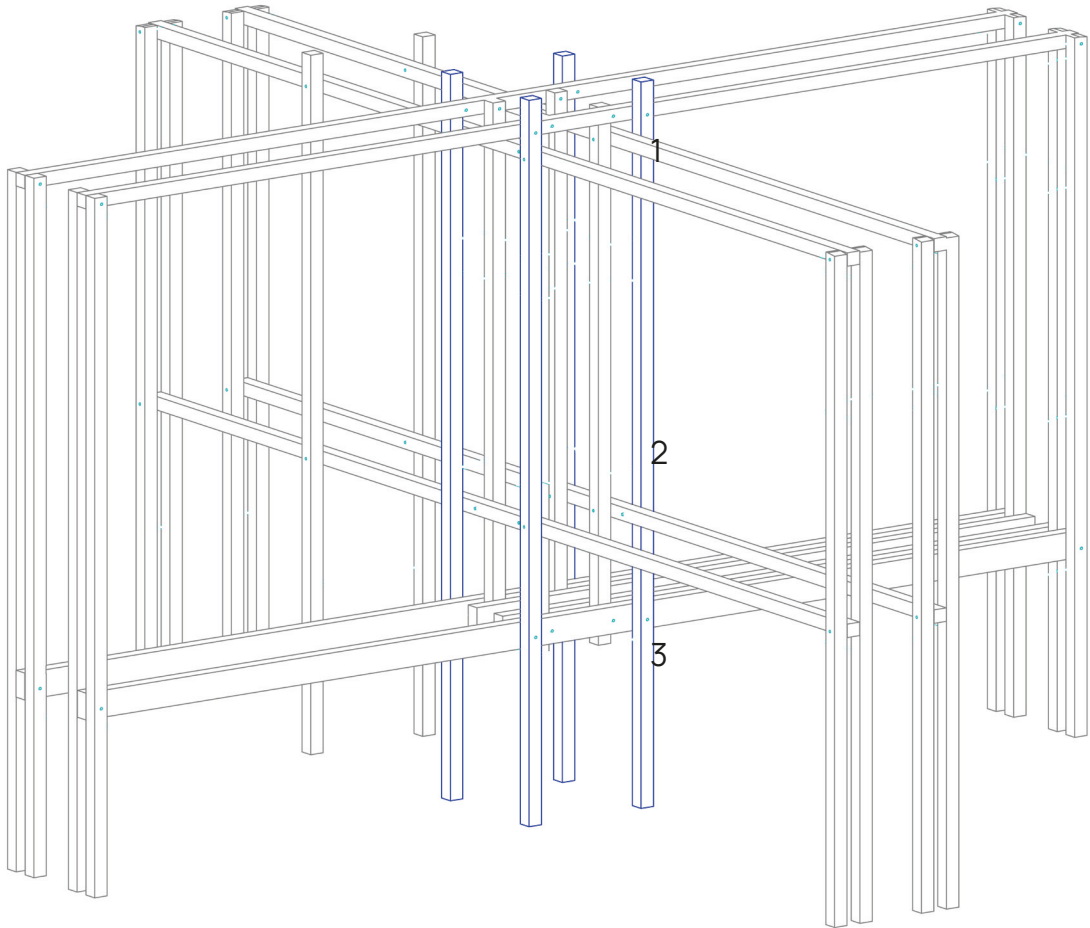
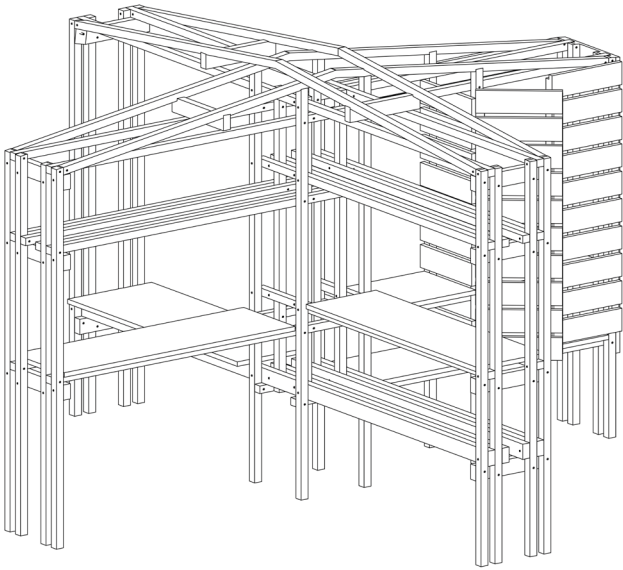

external columns

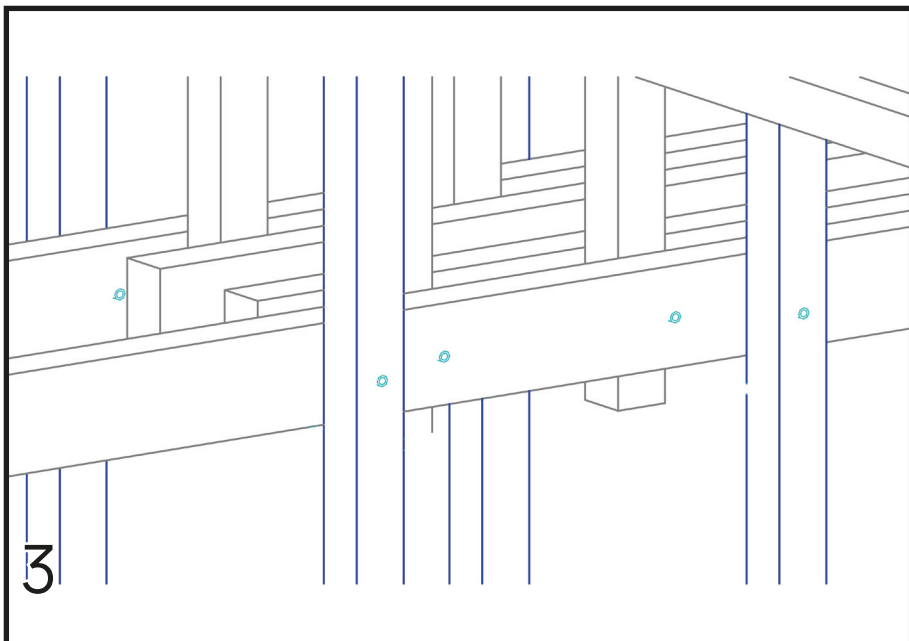
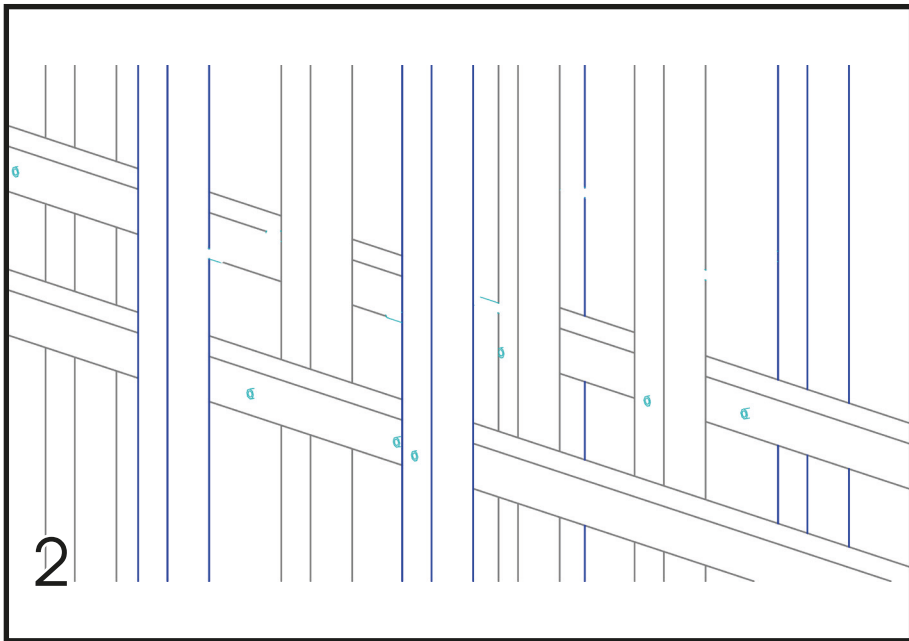
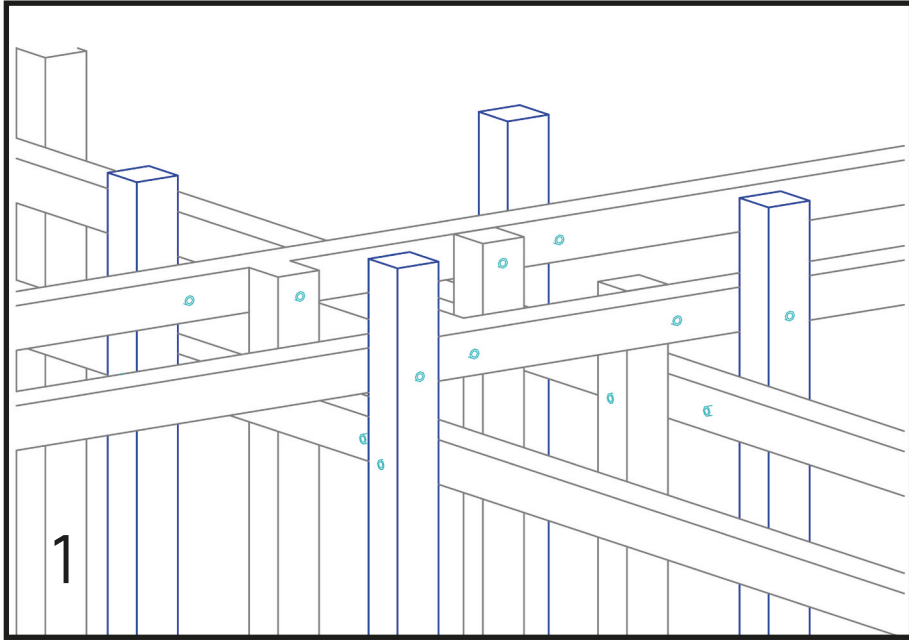

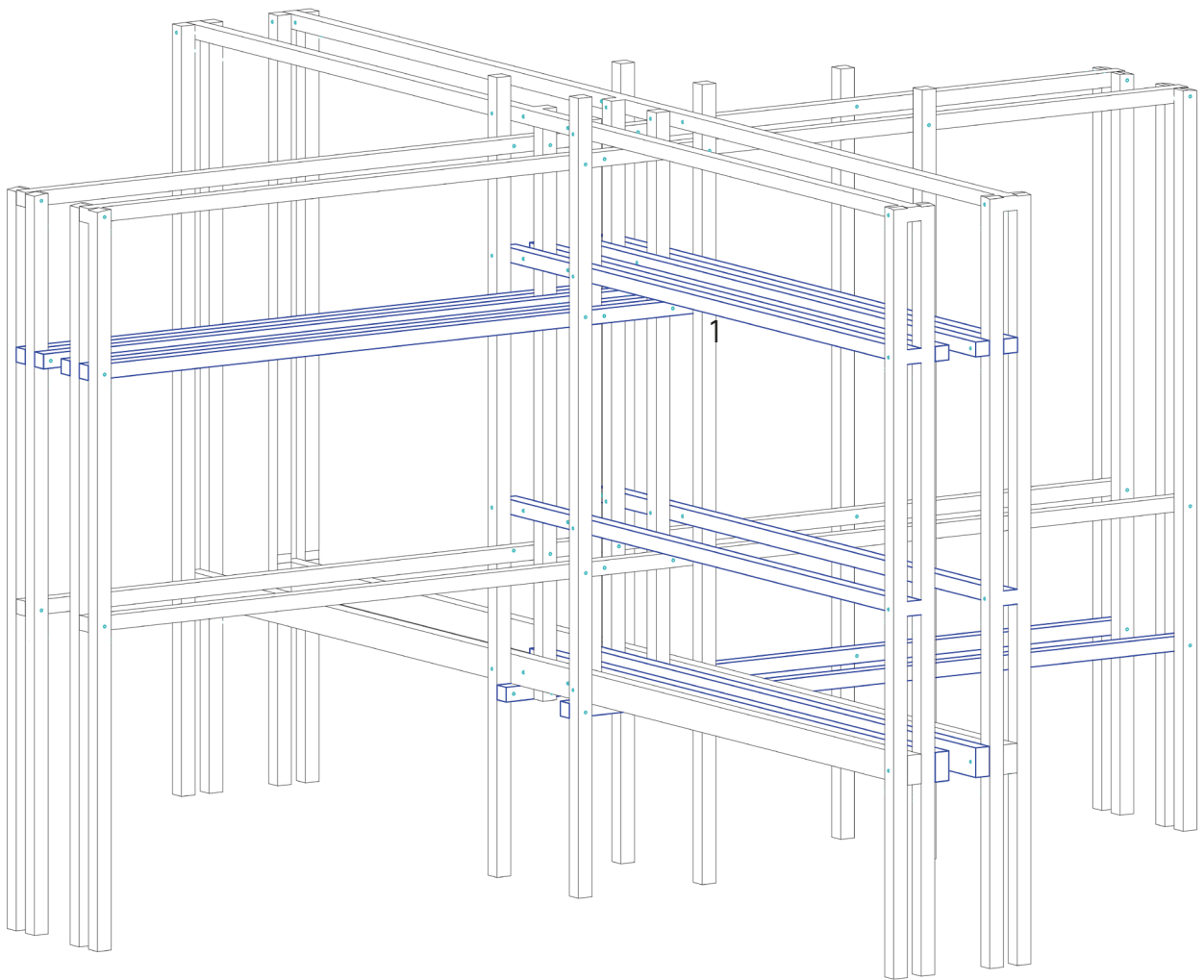
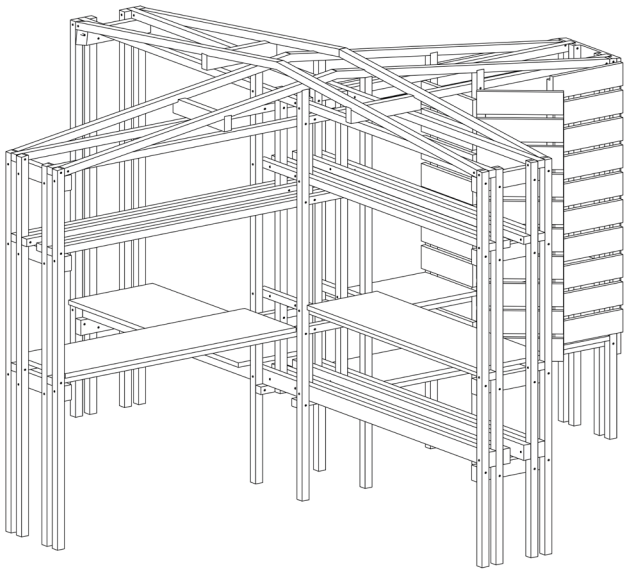

shelves

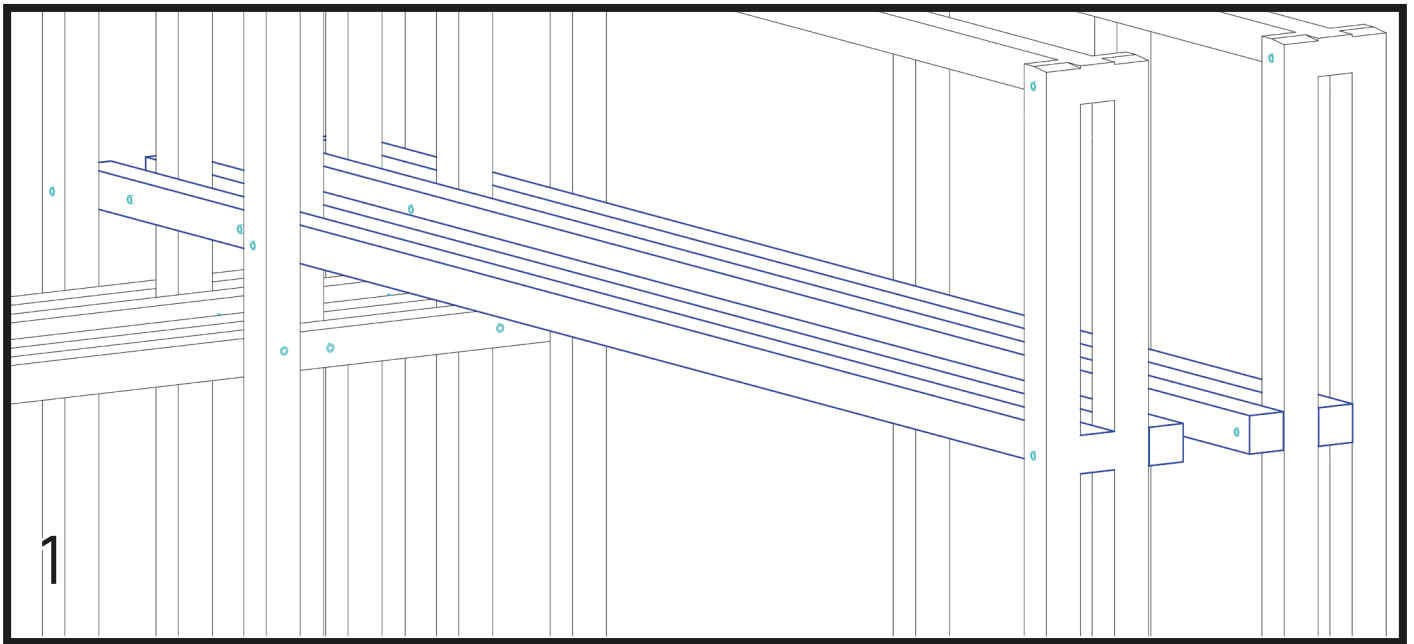

other shelves are attached in the same way

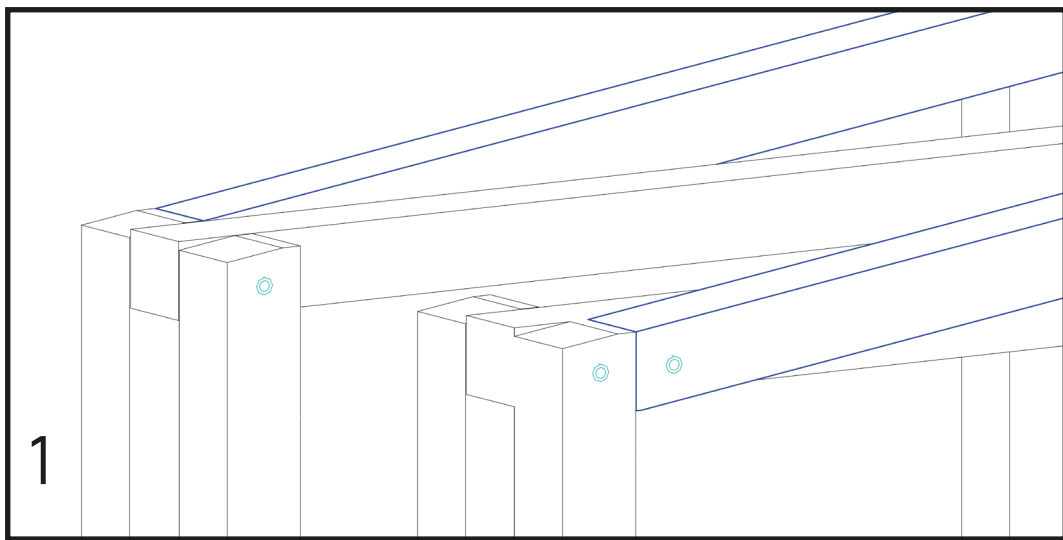
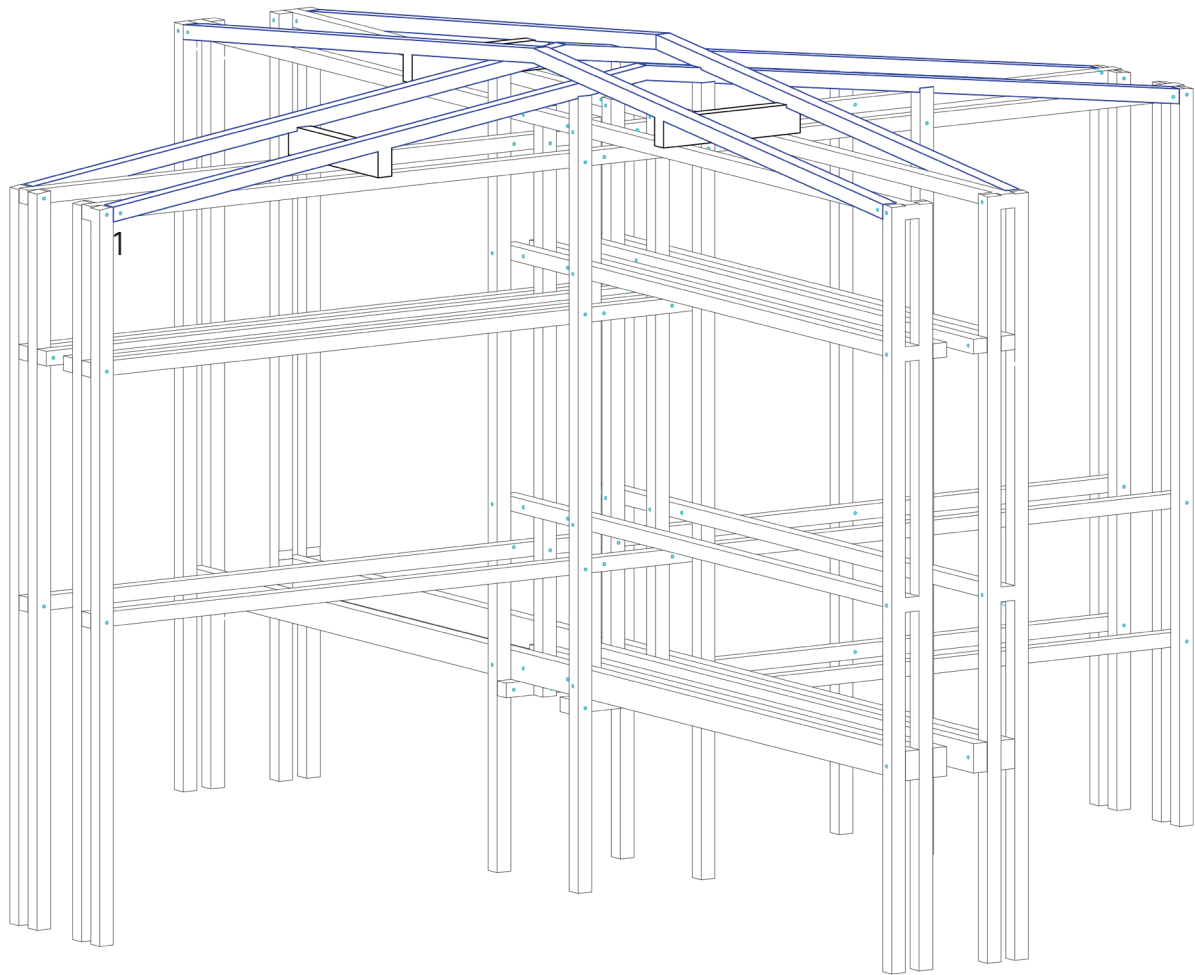

roof beams

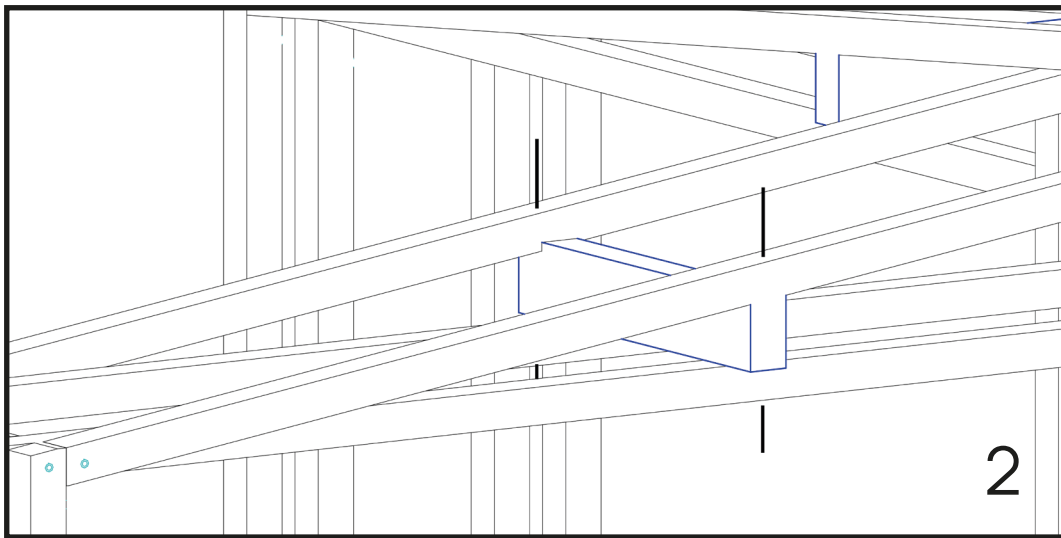
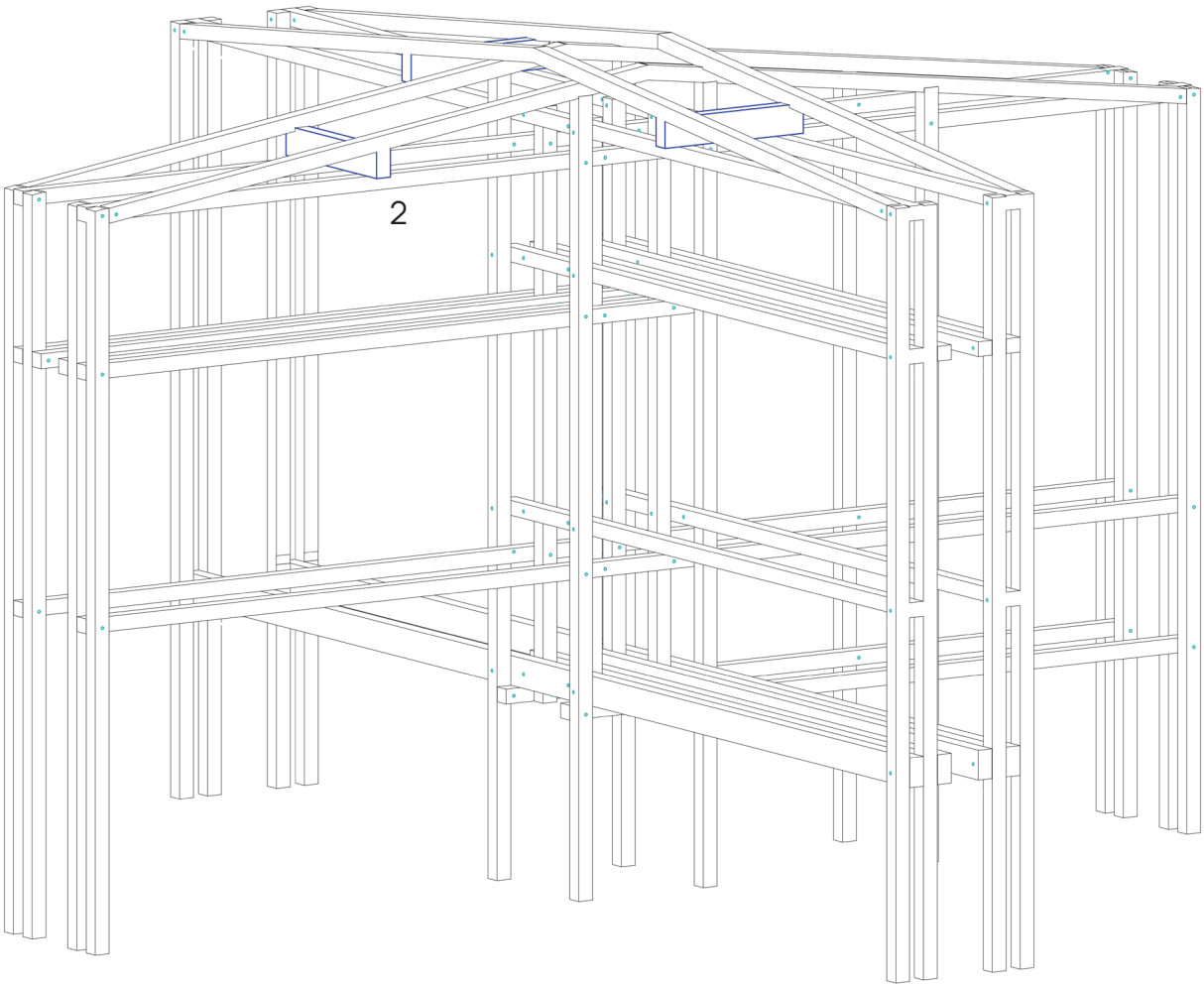

self-tapping screws are used here

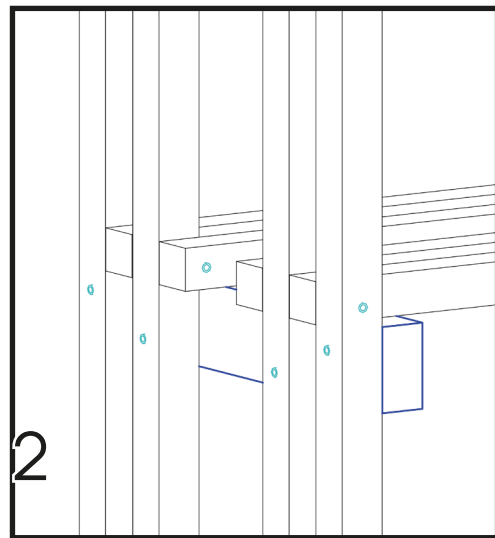
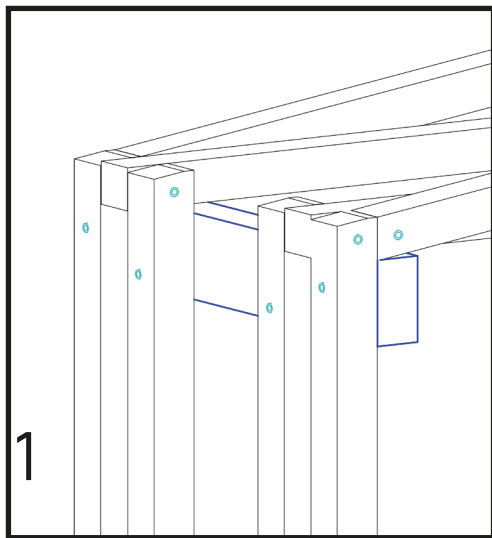
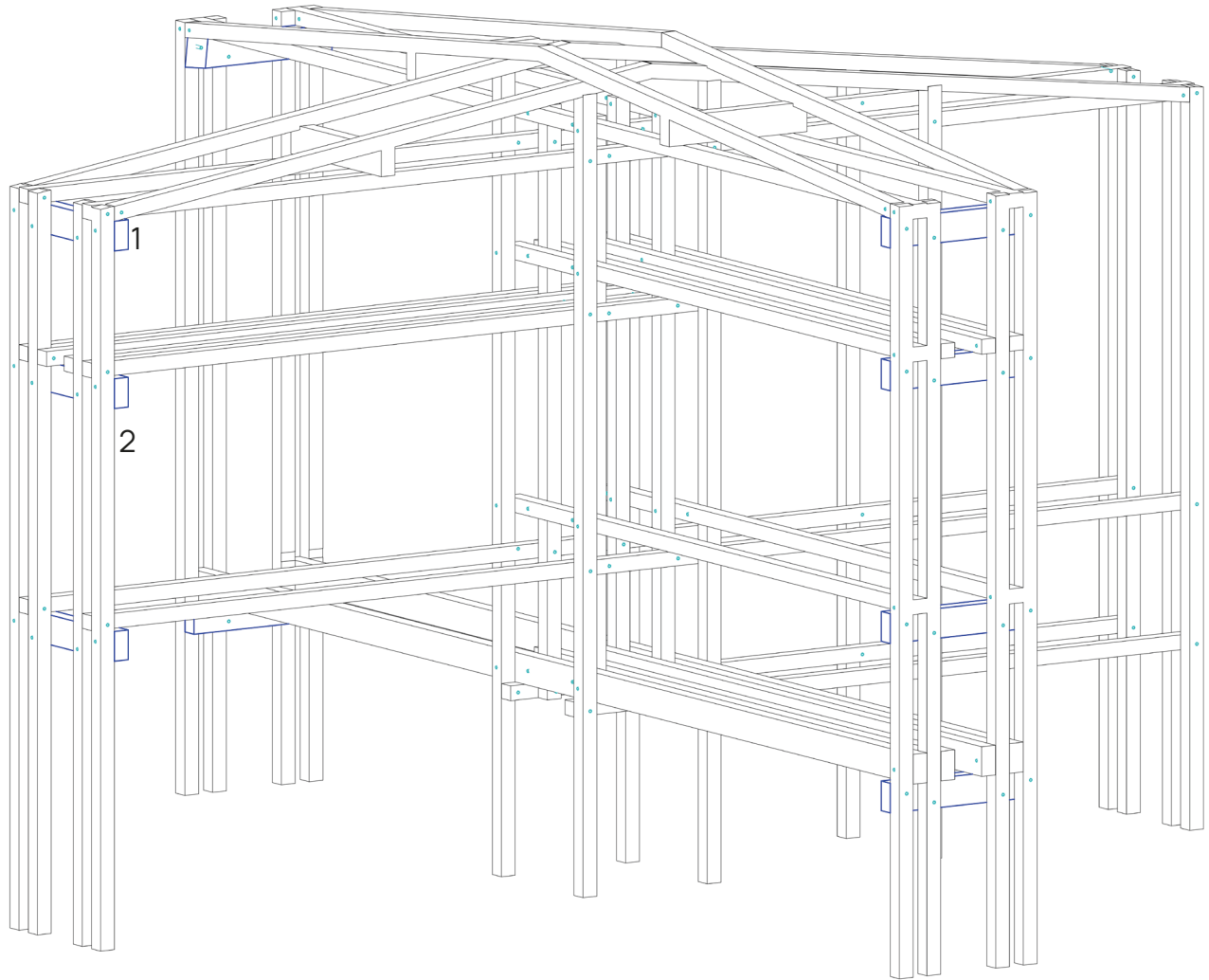

other support beams are attached in the same way

support beams

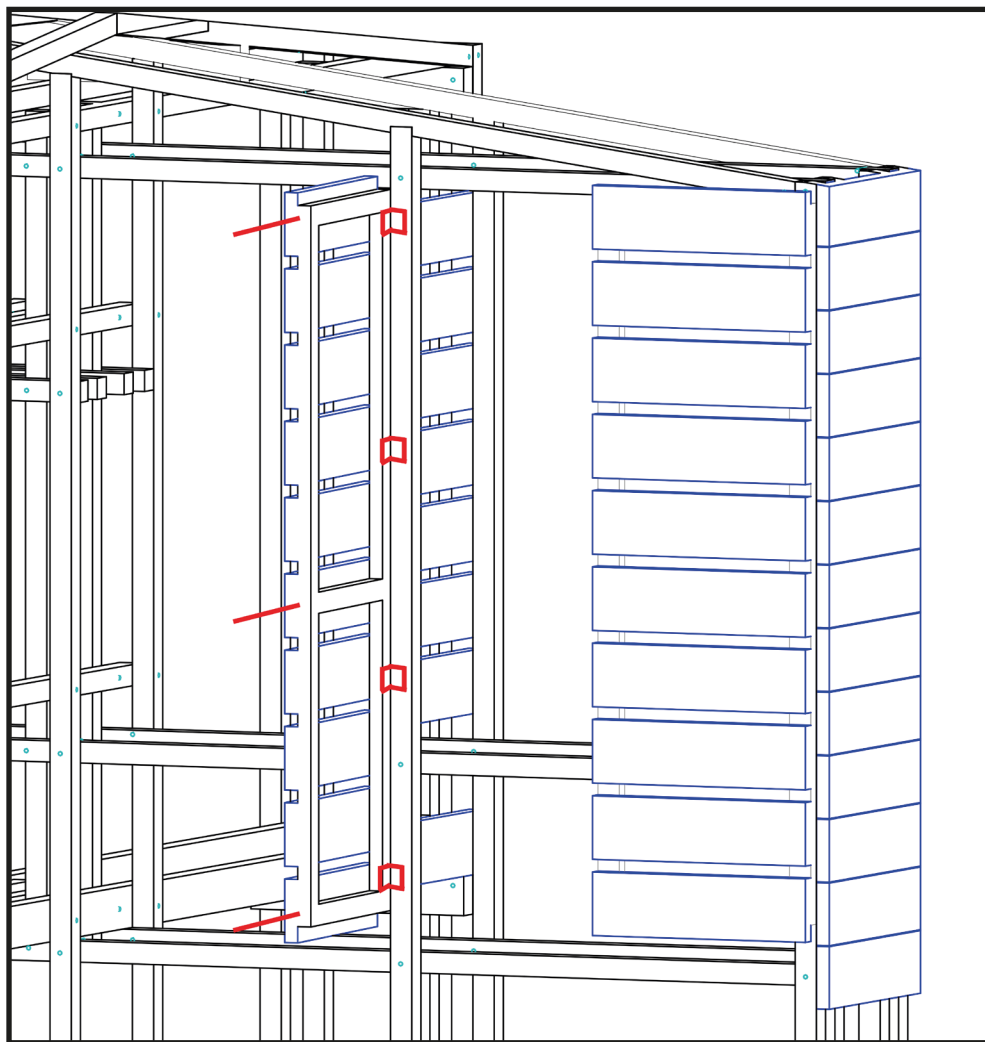
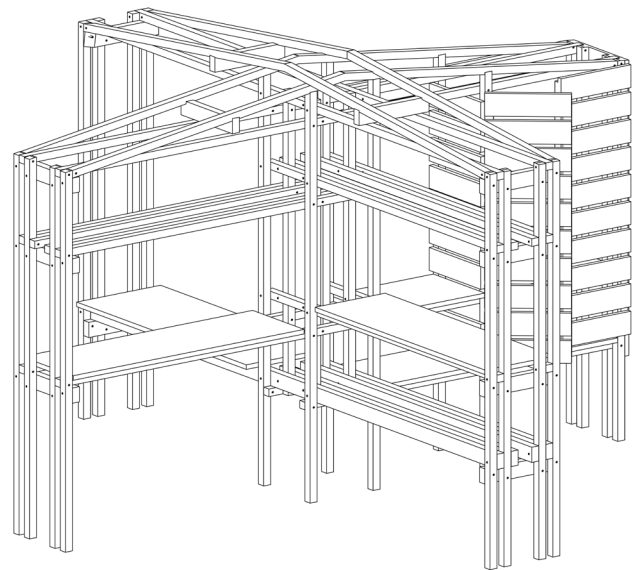

cabinet frame

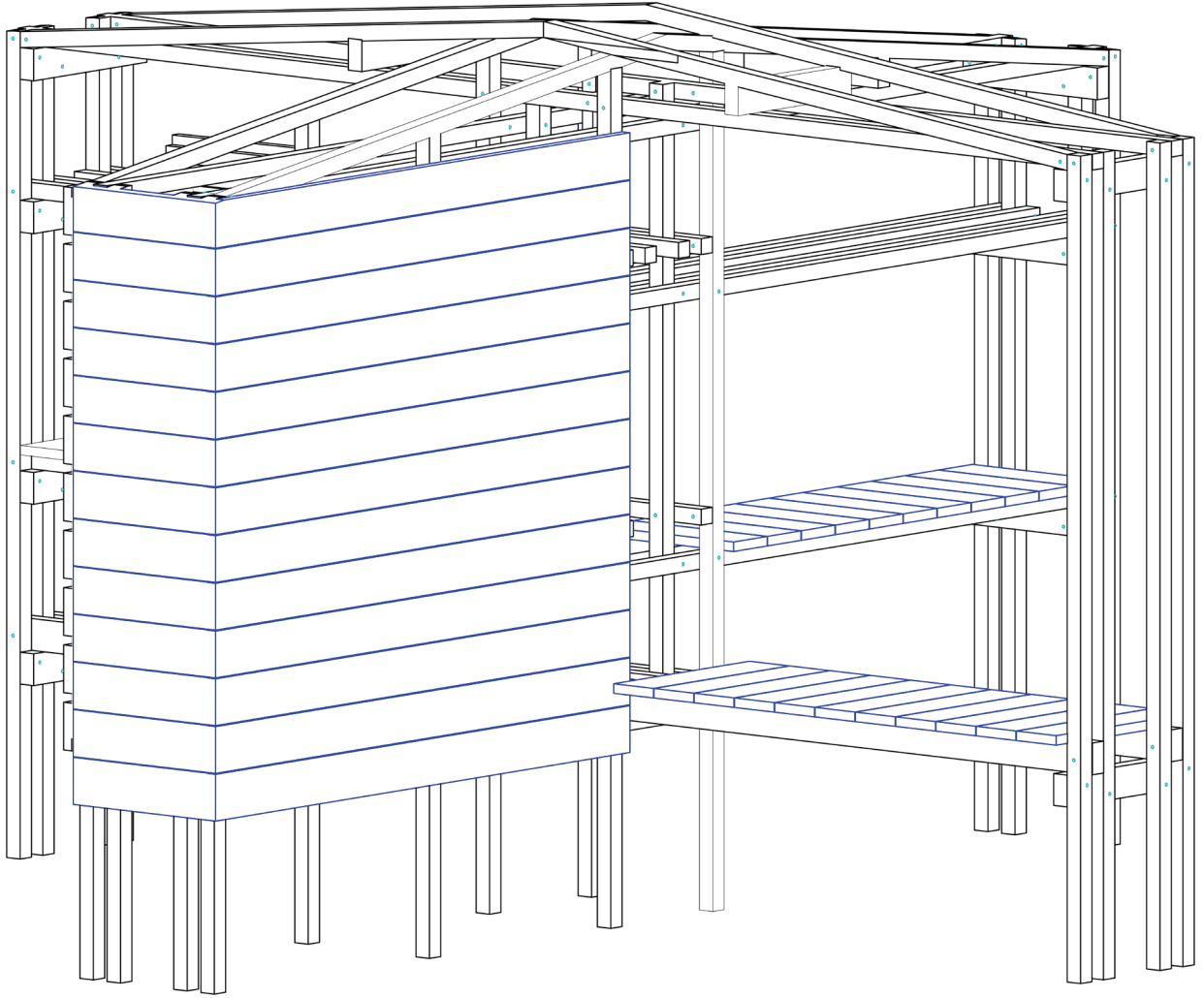

wood covering

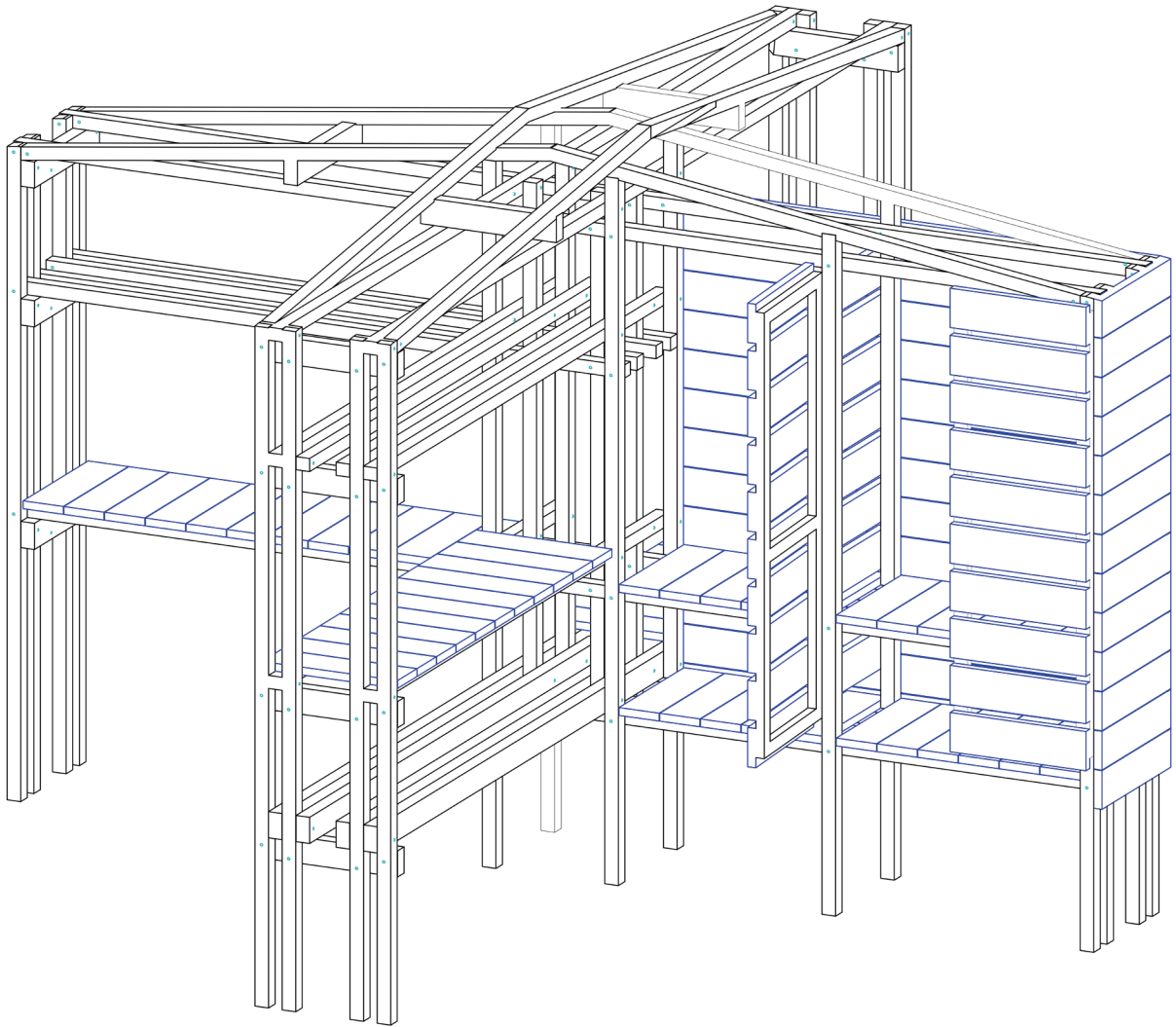

boards are attached to 2 screws on opposite sides

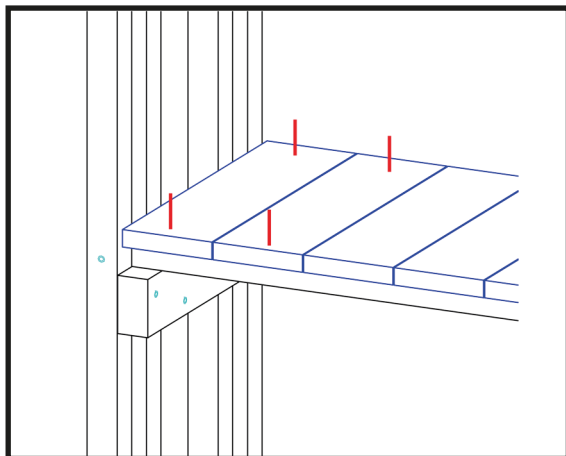

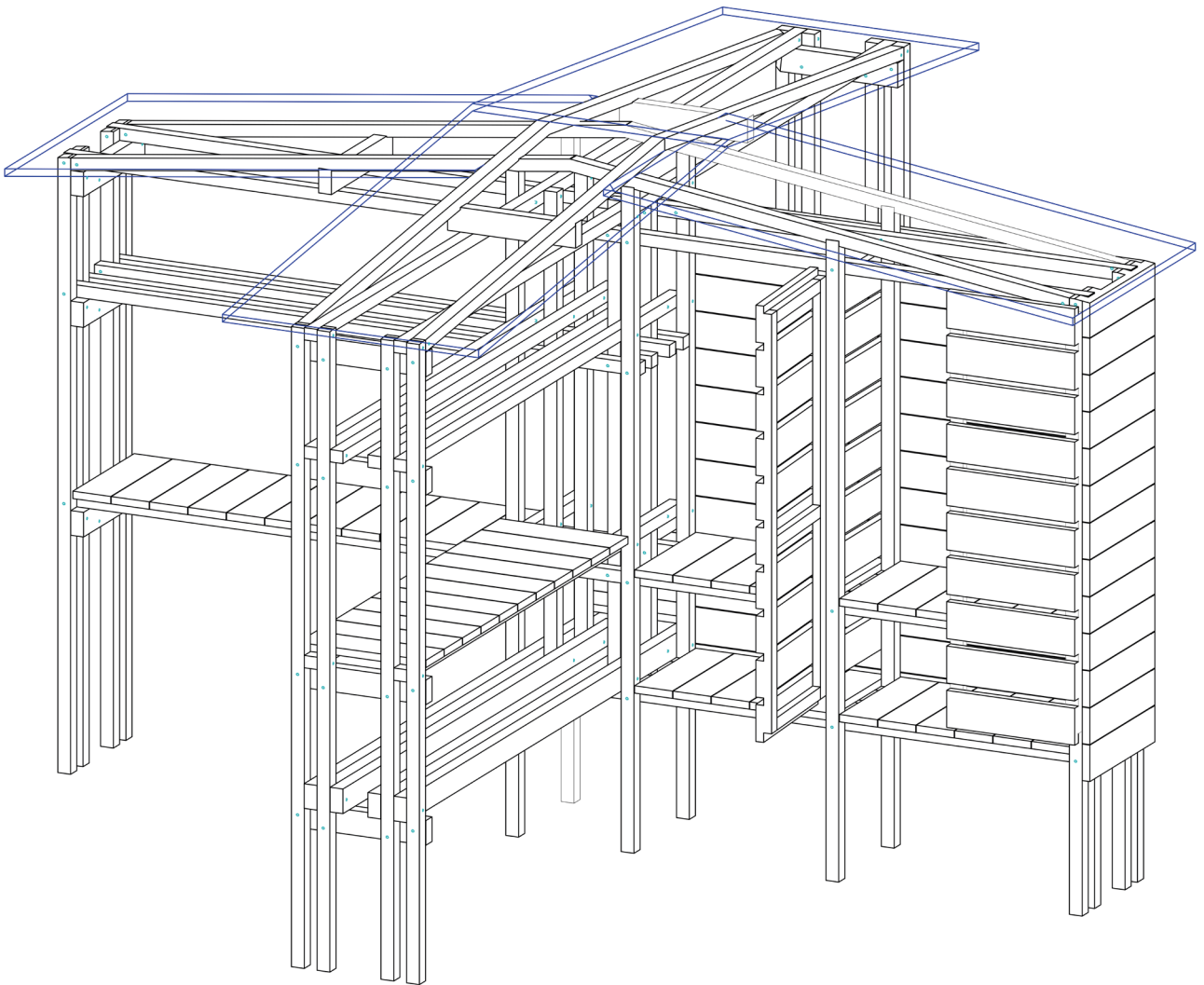

roof

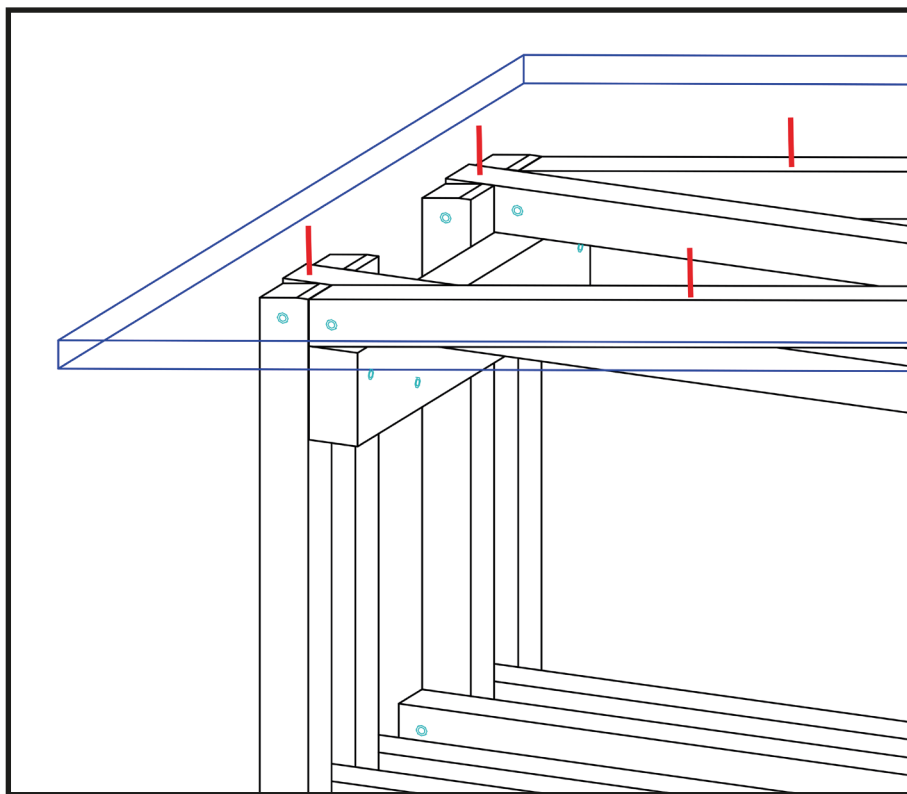

polycarbonate is mounted on 35 mm screws
profile connects the polycarbonate

